

Guidelines International Network Conference 2010



August 25-28, 2010

Chicago Marriott Downtown Magnificent Mile
Chicago, Illinois USA
www.gin2010.org

FINAL PROGRAM

**Integrating Knowledge.
Improving Outcomes.**



Hosted by:



Welcome to the Guidelines International Network Conference 2010

Letter From the G-I-N Chair

On behalf of the G-I-N Board of Trustees, I would like to welcome you to our seventh annual conference. The theme of the conference, Integrating Knowledge. Improving Outcomes, reflects why G-I-N came into being in the first place and why we need to work in collaboration to improve outcomes for patients wherever they are treated. We have an excellent scientific program, with high quality plenaries, presentations, workshops, and posters that should stimulate an equally high standard of debate. Most importantly, we have a wonderful opportunity to meet new people and catch up with old friends in a stimulating and learning environment.

I'd like to extend special thanks to Rick Shiffman, MD; Doreen Addrizzo-Harris, MD, FCCP; and the scientific committee for their hard work in bringing such an impressive program together; and to Sandy Zelman Lewis, PhD, ACCP Assistant Vice President, Health and Science Policy, and her colleagues at the ACCP for making the conference a reality.

Please come and say hello during the conference—the Board of Trustees is always happy to hear your thoughts and ideas. Have a great conference and enjoy Chicago.

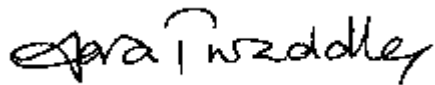

Sara Twaddle, PhD
Guidelines International Network 2009-2010, Chair

Letter From the G-I-N Scientific Program Committee Chair and Co-Chair

As Co-Chairs of the scientific program, we are delighted to welcome you to the Guideline International Network's seventh international conference. Our conference has become the premier venue for worldwide sharing of knowledge and experience about guideline development, dissemination, and implementation. Having reviewed the record number of abstracts submitted for this meeting, we are certain that the scientific program will be rewarding and satisfying. Our speakers provide insights and innovative solutions from around the corner and from distant continents.

Our plenaries, platform presentations, workshops, posters, and preconference meetings offer a rich buffet of answers and experiences, as well as new questions to explore. Perhaps even more important, the opportunity to meet and network with friends, colleagues, and new acquaintances who share our daily challenges makes the G-I-N meeting unique. The G-I-N Conference 2010 provides an informal atmosphere that fosters development of new friendships and cross-cultural relationships and collaborations.

Welcome to the USA and to Chicago!



Richard Shiffman, MD
G-I-N Conference 2010
Scientific Program Committee, Chair

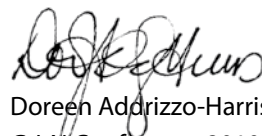

Doreen Addrizzo-Harris, MD, FCCP
G-I-N Conference 2010
Scientific Program Committee,
Co-Chair



Table of Contents

Welcome to Guidelines International Network Conference 2010	
Guidelines International Network Scientific Committee.....	2
The Guidelines International Network	3
Registration and Conference Information.....	4
Chicago Marriott Downtown Magnificent Mile floor plan.....	6
Meeting Highlights.....	8
Program-At-A-Glance.....	8
Plenary Speakers	10
Curriculum by Topic.....	15
Curriculum by Date.....	17
Wednesday, August 25.....	17
Thursday, August 26	18
Friday, August 27.....	24
Saturday, August 28	29
Poster Sessions I and II.....	32
Social Events and Networking Opportunities.....	36
Additional Meetings	37
G-I-N Member Open Meeting.....	37
Exhibitors.....	38
General Information.....	40
Chicago Area Map.....	40
Welcome to Chicago	41
Continuing Medical Education Credits.....	42
Conflict of Interest Disclosures	43
Speaker index	45

Guidelines International Network Scientific Program Committee



Richard Shiffman, MD, Chair
Yale University



Doreen Addrizzo-Harris, MD, FCCP,
Co-Chair
New York University School
of Medicine

Hyeongsik Ahn, MD, PhD
Korea University

David Atkins, MD, MPH
US Department of Veterans Affairs

Dave Davis, MD
University of Toronto

Kay Dickersin, PhD
Johns Hopkins
Cochrane Collaborative, United States

Ian Graham, PhD
Canadian Institutes of Health Research

Eeva Ketola, MD, PhD
Current Care – Finnish Medical Society Duodecim

Eddy Lang, MDCM
SMBD Jewish General Hospital

Val Moore, MSc
National Institute for Health and Clinical Excellence
(NICE), United Kingdom

Virginia Moyer, MD, MPH
Texas Children's Hospital
Baylor College of Medicine

Sue Phillips, PhD
National Institute of Clinical Studies

Amir Qaseem, MD, PhD
American College of Physicians

Rosa Rico-Iturrioz, MSc
Basque Office for Health Technology Assessment

Richard Rosenfeld, MD, MPH
SUNY Downstate Medical Center, Long Island College
Hospital

G-I-N Abstract Review Committee

Susan M. Harding, MD, FCCP

Robert C. Hyzy, MD, FCCP

Norm Kato, MD, FCCP

Praveen N. Mathur, MBBS, FCCP

Janet R. Maurer, MD, FCCP

Mark Metersky, MD, FCCP

COL Lisa K. Moores, MC, USA, FCCP

Ian T. Nathanson, MD, FCCP

Daniel R. Ouellette, MD, FCCP



The Guidelines International Network (G-I-N)

G-I-N Overview

The Guidelines International Network (G-I-N) is an international not-for-profit association of organizations and individuals involved in the development and use of clinical practice guidelines. G-I-N supports international collaboration to improve the quality of health care by promoting systematic evidence review, rigorous development of clinical practice guidelines, and application into practice. Founded in 2002, G-I-N has grown to include 93 organization members and partners representing 38 countries from Africa, North America, South America, Asia, Europe, and Oceania. G-I-N has also developed partnerships with the following: The AGREE Research Trust, The GRADE Working Group, The ADAPTE Collaboration, The International Network of Agencies for Health Technologies Assessment, and The World Medical Association.

www.g-i-n.net

G-I-N Products and Services

- G-I-N International Guideline Library. This is the world's largest guideline library that is regularly updated with the latest information on guidelines from G-I-N membership.
- G-I-N Working Groups. G-I-N facilitates the sharing of expertise and networking through topic-related working groups, such as evidence tables, public and patient involvement, and disease management.
- G-I-N Emergency Care Community of Interest
- Guideline Tools Inventory
- Development and Training Resources
- Health Topics Collection
- Patient and Consumer Resources
- AGREE Instrument for Guideline Appraisal
- International G-I-N Conferences (annual scientific education meetings)

Registration and Conference Information

Registration and information desks are located on the 7th floor of the Chicago Marriott Downtown Magnificent Mile. These areas are open during the following times:

- Wednesday, August 25 - 7:00 AM TO 7:00 PM
- Thursday, August 26 - 6:30 AM TO 5:35 PM
- Friday, August 27 - 7:00 AM TO 5:30 PM
- Saturday, August 28 - 7:00 AM TO 12:30 PM

Registration Fee Inclusions

The G-I-N Conference 2010 registration fee (*excluding the 1-day registration categories*) includes the following:

- The Welcoming Reception (August 25, 2010)
- One Gala Event ticket (August 27, 2010) is included in the G-I-N/ACCP member registration rate ONLY. Additional gala tickets may be purchased for all others/guests separately.

G-I-N Conference 2010 Abstracts

Full versions of the G-I-N Conference 2010 submitted abstracts can be viewed online at www.gin2010.org and at the Journal of the American Academy of Otolaryngology-Head and Neck Surgery Foundation, Inc. site, www.otojournal.org.

Badges

All participants, accompanying guests, press, and exhibitors must wear their name badge during the conference and social events.

G-I-N Members: Red

G-I-N Board/Scientific Committee: Blue

Plenary Speakers: Green

2011 Scientific Committee: Teal

Exhibitors: Orange

Supporters: Purple

Press: White

If you need a replacement badge, please present your registration confirmation letter or a copy of your on-site registration form as proof of your registration.

Presenter Information

G-I-N Conference 2010 workshop and parallel presentation presenters are responsible for uploading their presentations in their assigned presentation room at the Chicago Marriott prior to their scheduled session. Excluding Saturday morning, when presenters can upload their presentations from 7:00 AM to 7:30 AM, presenters have the option of uploading their presentations during either the morning or afternoon break on the day of their scheduled presentation. Technicians will assist presenters in uploading their presentations directly on the computer in their scheduled session room prior to their presentation.



Conference Language

The official language of the G-I-N Conference 2010 is English. No simultaneous interpretations will be provided.

Facilities at the Venue

The Chicago Marriott Downtown Magnificent Mile is equipped with a business center, copy/fax service, ATM machines, foreign currency exchange, and wireless Internet access in the hotel lobby. Participants will also find gift shops and newsstands at the hotel.

Insurance/Liability

Participation at the G-I-N Conference 2010 implies that persons/participants agree that the organizers do not assume any liability whatsoever. Upon registration, the participant accepts this provision.

Program Changes

The organizers cannot assume liability for changes in the program due to external or unforeseen circumstances.

Photographs

Photographs, audiotapes, and videotapes are periodically taken during the conference. All program attendees agree that the ACCP/G-I-N may use any photograph, audiotape, or videotape in their publications, displays, Web sites, or in any other ACCP/G-I-N material without providing additional notice or compensation.

Breakfast

Breakfast is the responsibility of the attendee.

The hotel offers an in-room dining breakfast service. Hotel guests may also enjoy breakfast at the hotel restaurant, Harvest, offering contemporary and classic American food. Starbucks Coffee, located in the hotel lobby, also offers breakfast options.

Morning and Afternoon (Coffee) Breaks

Coffee breaks are scheduled for the following times during the conference:

Thursday, August 26

Morning Break 10:15 AM – 10:45 AM

Afternoon Break 3:35 PM – 4:05 PM

Friday, August 27

Morning Break 9:45 AM – 10:15 AM

Afternoon Break 3:00 PM – 3:30 PM

Saturday, August 28

Morning Break 9:30 AM – 10:00 AM

No Afternoon Break

Lunch

Lunches are included in the registration fees for all conference attendees and will be offered in Salon I/II on the 7th floor. The lunch schedule is as follows:

Thursday, August 26

12:15 PM – 1:25 PM

Friday, August 27

11:45 AM – 12:50 PM

Saturday, August 28

Lunch is not offered.

Chicago Marriott Downtown Magnificent Mile Meeting Rooms

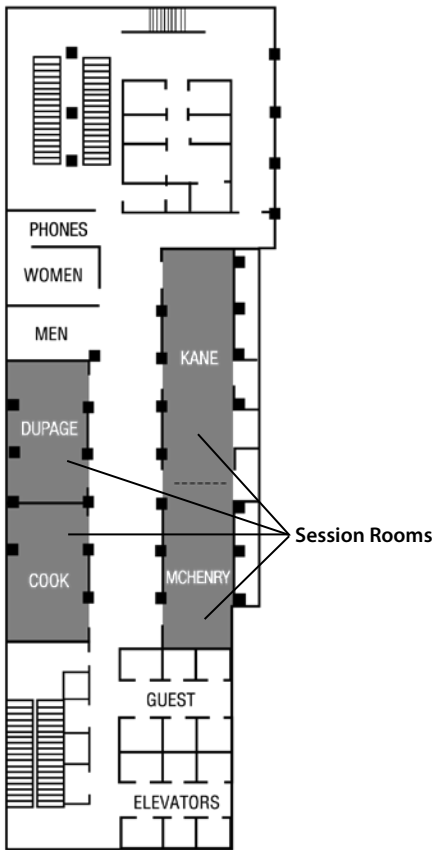

3rd Floor

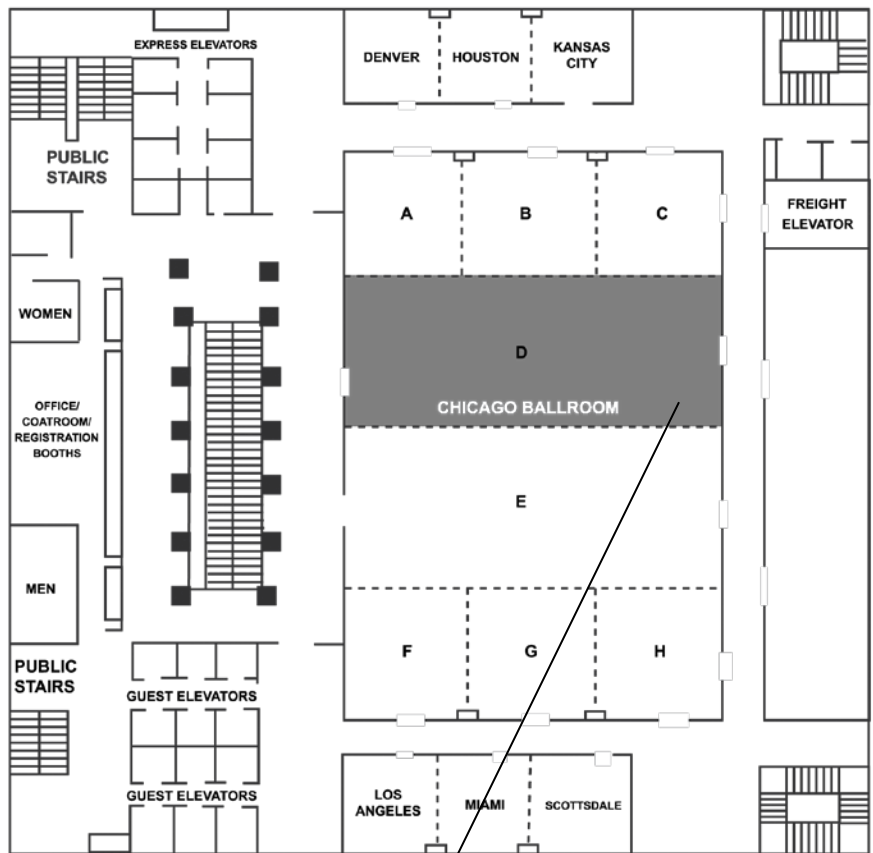

5th Floor

Session Rooms

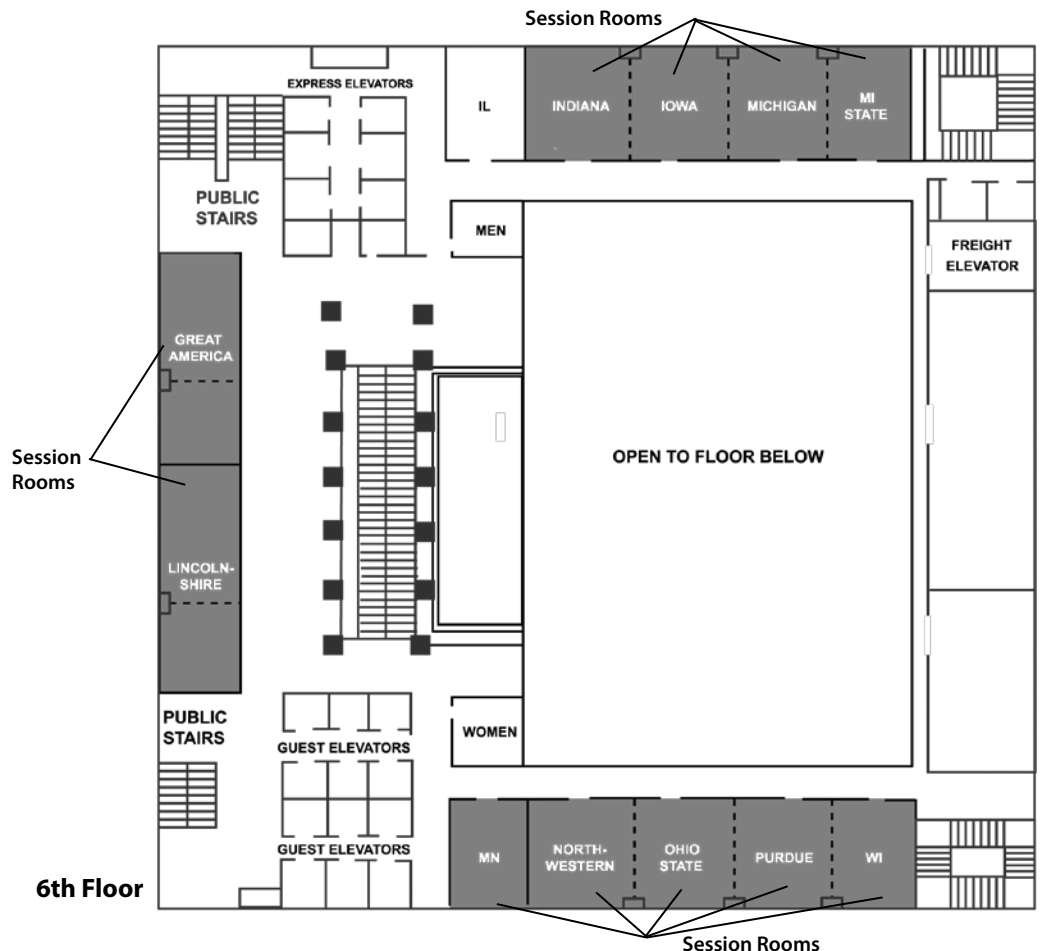

Meeting Highlights

**Wednesday,
August 25, 2010**

**Thursday,
August 26, 2010**

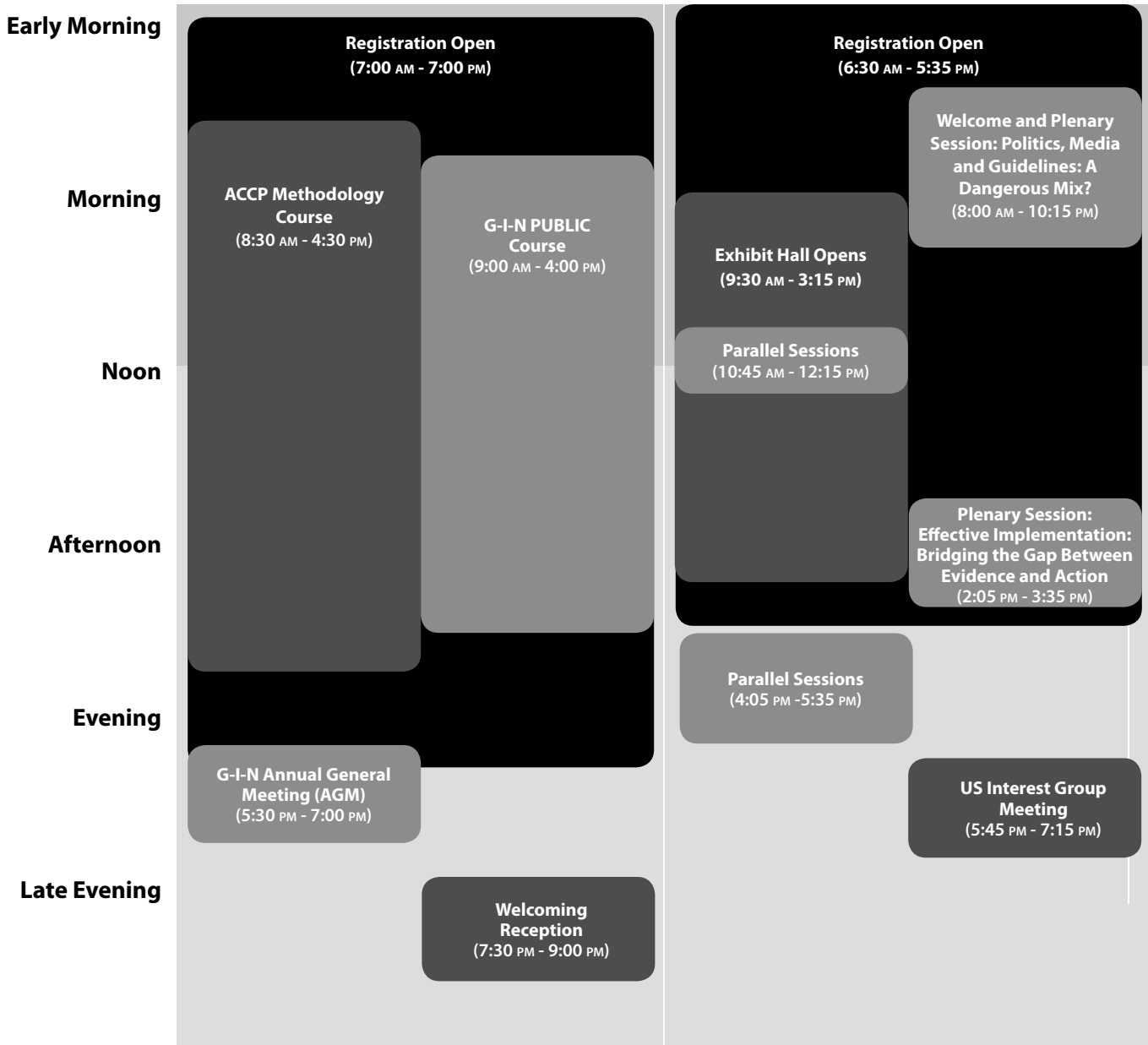



**Friday,
August 27, 2010**

**Saturday,
August 28, 2010**

Registration Open
(7:00 AM - 5:30 PM)

**Plenary Session:
Challenges in Managing
Conflict of Interest in
Guideline Development**
(8:00 AM - 9:45 AM)

Exhibit Hall Opens
(9:30 AM - 3:15 PM)

**Plenary Session:
A Seat at the Table: The
Effects of Consumer
Engagement in Guideline
Development**
(1:30 PM - 3:00 PM)

Parallel Sessions
(3:30 PM - 5:00 PM)

Gala Event
(6:00 PM - 11:00 PM)

Registration Open
(7:00 AM - 12:30 PM)

**Closing Remarks and
Plenary Session: Rationing
or Rationality? Health
Economics in National
Guidance**
(10:00 AM - 12:00 PM)

Meeting Highlights

Plenary Speakers



Ceci Connolly
National Staff Writer
The Washington Post
Washington, DC

Politics, Media, and Guidelines: A Dangerous Mix?

Thursday, August 26

8:00 AM - 10:15 AM

Chicago Marriott Downtown, Salon III (7th Floor)

Ceci Connolly has been a national staff writer at *The Washington Post* since 1997, covering national politics, health care, and several major disasters, such as Hurricane Katrina. As the national health policy correspondent for *The Washington Post*, she spent the past year chronicling President Obama's drive for sweeping health-care legislation. She frequently appears as a commentator on national television and is popular on the public speaking circuit. She is one of the lead authors of *LANDMARK: The Inside Story of America's New Health Care Law and What It Means for Us All*.



Catherine D. DeAngelis, MD, MPH
Editor in Chief, *JAMA*
Chicago, IL

Challenges in Managing Conflict of Interest in Guideline Development

Friday, August 27

8:00 AM - 9:45 AM

Chicago Marriott Downtown, Salon III (7th Floor)

Dr DeAngelis is Editor in Chief of the *Journal of the American Medical Association* and Professor of Pediatrics, Johns Hopkins University, School of Medicine. She has

been awarded seven honorary doctorate degrees and has received numerous awards for humanitarianism and medical excellence. Dr. DeAngelis is a former council member of the National Academy of Science, Institute of Medicine, a Fellow of the American Association for the Advancement of Science, and has served as an officer of numerous national academic societies. She currently serves on the Advisory Board of the US Government Accountability Office.



Kay Dickersin, MA, PhD
Director, Center for Clinical Trial
Epidemiology
Johns Hopkins University
Johns Hopkins Bloomberg School
of Public Health
Baltimore, MD

A Seat at the Table: The Effects of Consumer Engagement in Guideline Development

Friday, August 27

1:30 PM - 3:00 PM

Chicago Marriott Downtown, Salon III (7th Floor)

Dr Dickersin is Professor at the Johns Hopkins Bloomberg School of Public Health, Director of the Center for Clinical Trial Epidemiology, and Director of the US Cochrane Center (USCC), 1 of 13 centers worldwide participating in The Cochrane Collaboration. The USCC supports Consumers United for Evidence-Based Healthcare (CUE), a partnership with health and consumer advocacy organizations, started in 2003.



Martin Eccles, MD
 Professor of Clinical Effectiveness
 and The William Leech Professor
 of Primary Care Research
 Newcastle University
 Newcastle upon Tyne, UK

**Effective Implementation:
 Bridging the Gap Between Evidence and Action**

Thursday, August 26
 2:05 PM - 3:35 PM
 Chicago Marriott Downtown, Salon III (7th Floor)

Dr Eccles directs the Effective Practice and Organisation of Care research program within The Institute of Health & Society, Newcastle University. He is a Fellow of the Academy of Medical Sciences, the Royal College of Physicians, the Royal College of General Practitioners, and the Faculty of Public Health. He is a Visiting Professor at the Ottawa Health Research Institute and is founding Co-Editor in Chief of the open access electronic journal *Implementation Science* and an editor for the Cochrane Effective Practice and Organisation of Care (EPOC) group. He is a practicing general practitioner.



Theodore G. Ganiats, MD
 Professor and Interim Chair
 Department of Family and
 Preventive Medicine
 University of California San Diego
 School of Medicine
 San Diego, CA

**A Seat at the Table: The Effects of Consumer
 Engagement in Guideline Development**

Friday, August 27
 1:30 PM - 3:00 PM
 Chicago Marriott Downtown, Salon III (7th Floor)

Dr Ganiats is a family physician who is also a health services researcher who focuses on quality of life and cost-effectiveness. He has participated on over 40

national guideline and performance improvement panels and has done research on shared decision making.



Roberto Grilli, MD
 Director of the Regional Agency
 for Health and Social Care of
 Emilia-Romagna
 Bologna, Italy

**Effective Implementation:
 Bridging the Gap Between Evidence and Action**

Thursday, August 26
 2:05 PM - 3:35 PM
 Chicago Marriott Downtown, Salon III (7th Floor)

Dr Grilli is a health services researcher whose areas of interest include quality of care assessment and improvement, health-care technology assessment, development and implementation of practice guidelines, governance in health-care organizations, and development of policies for promoting research and innovation in health services. From 1994 up to 2006, he was among the editors of the Cochrane Effective Practice and Organisation of Care (EPOC).



Gill Gyte, BSc, MPhil
 Cochrane Pregnancy and
 Childbirth Group
 University of Liverpool
 Liverpool, UK

**A Seat at the Table: The Effects of Consumer
 Engagement in Guideline Development**

Friday, August 27
 1:30 PM - 3:00 PM
 Chicago Marriott Downtown, Salon III (7th Floor)

Gill Gyte has worked with the Cochrane Pregnancy and Childbirth Group since 1997, bringing women's views to the Cochrane reviews in that group. She is very interested in guideline development and dissemination and has been a consumer representative on two NICE guidelines and one WHO guideline. She has commented as a consumer on a number of other guidelines. Gill Gyte received the 2003 Chris Silagy Prize in recognition of her contribution to the Cochrane Collaboration.



Finn Børlum Kristensen, MD, PhD
 Professor, University of Southern
 Denmark
 Director, Coordinating Secretariat,
 EUnetHTA
 Chairman of the EUnetHTA
 Executive Committee
 Copenhagen, Denmark

**Rationing or Rationality?
 Health Economics in National Guidance**

Saturday, August 28
 10:00 AM - 12:00 PM
 Chicago Marriott Downtown, Salon III (7th Floor)

Dr Kristensen is a public health physician and general practitioner and holds an adjunct professorship in Health Services Research and Health Technology Assessment (HTA) at the Faculty of Health Sciences of University of Southern Denmark. He was the Director of Danish Centre for Health Technology Assessment from

1997 to 2009 and promoted the establishment of the Danish Secretariat for Clinical Guidelines in 2000. He now works on international collaboration in HTA and leads a joint action between the European Commission and the EU Member States involving 34 government-nominated partners from 24 European countries. He was a founding member of the G-I-N Board of Trustees.



Fergus Macbeth, MD
 Director, Centre for Clinical Practice
 National Institute for Health and
 Clinical Excellence
 London, UK

**Rationing or Rationality?
 Health Economics in National Guidance**

Saturday, August 28
 10:00 AM - 12:00 PM
 Chicago Marriott Downtown, Salon III (7th Floor)

Dr Macbeth has been Director of the clinical guidelines programme at NICE for almost 2 years. He has worked as a consultant oncologist for over 20 years and been involved with guideline development for 15 years, chairing a guideline group for SIGN and running a team in Cardiff, developing cancer guidelines for NICE. He is involved with clinical trials in lung cancer and is Joint Coordinating Editor of the Cochrane Lung Cancer Review group.



Marjukka Mäkelä, MD, PhD
 Research Professor, Editor-in-Chief
 Finnish Office for Health
 Technology Assessment
 Helsinki, Finland

**Challenges in Managing Conflict of Interest in
 Guideline Development**

Friday, August 27
 8:00 AM - 9:45 AM

Chicago Marriott Downtown, Salon III (7th Floor)

Dr Mäkelä is the Director of the Finnish Office for Health Technology Assessment (FINOHTA) at THL (National Institute for Health and Welfare) in Finland. A general practitioner by first training, her main interest is to support evidence-based decisions by providing relevant and reliable information to patients, clinicians, and policymakers. Dr Mäkelä joined the G-I-N Board of Trustees for several years, also as Vice-Chair and Chair.

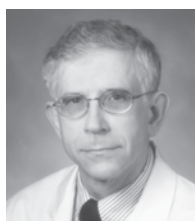

Joel Moss, MD, PhD
 Deputy Chief
 Translational Medicine Branch
 National Heart, Lung, and Blood
 Institute
 National Institutes of Health
 Bethesda, MD

**Challenges in Managing Conflict of Interest in
 Guideline Development**

Friday, August 27
 8:00 AM - 9:45 AM

Chicago Marriott Downtown, Salon III (7th Floor)

Dr Moss graduated from Brandeis University, summa cum laude, and received MD - PhD (biochemistry) degrees from New York University School of Medicine. Following internship and residency (medicine, John Hopkins Hospital), he completed postdoctoral and pulmonary fellowships (NHLBI). At NHLBI since 1974, he has coauthored over 575 scientific papers, edited/coauthored several books, including one on ethical

considerations in clinical research, and is a co-inventor of biotechnology patents. Dr Moss was a member of the NHLBI Institutional Review Board from 1988 to 2006, and Chair from 1995 to 2006. Subjects of his clinical research include destructive lung diseases, eg, lymphangioleiomyomatosis (LAM) and cystic fibrosis. His basic research focuses on guanine nucleotide-binding proteins in vesicular trafficking and the effects of ADP-ribosylation, a posttranslational modification of proteins, in health and disease. Dr. Moss is a member of the American Society for Biochemistry and Molecular Biology, Association of American Physicians, American Thoracic Society, and American Society for Clinical Investigation (ASCI). He has been an ASCI Councilor and Vice President.

Jennifer J. Padberg, MPH
 Vice President of Clinical Affairs
 Infectious Diseases Society of America (IDSA)
 Arlington, VA

Politics, Media, and Guidelines: A Dangerous Mix?

Thursday, August 26
 8:00 AM - 10:15 AM

Chicago Marriott Downtown, Salon III (7th Floor)

Jennifer Padberg has been involved in guideline development at various medical-specialty organizations since 1996. As VP of Clinical Affairs, she has oversight of a growing practice guideline program, quality improvement initiatives, and general physician practice-related issues. Jennifer holds a Master of Public Health degree in epidemiology and biostatistics.



Trudy van der Weijden, MD
Senior Lecturer
Department of General Practice
Centre for Quality of Care Research
University of Maastricht
Maastricht, Netherlands

A Seat at the Table: The Effects of Consumer Engagement in Guideline Development

Friday, August 27
1:30 PM - 3:00 PM
Chicago Marriott Downtown, Salon III (7th Floor)

Dr van der Weijden received her medical degree in 1989 and made a choice for full-time research early in her career. She certified as an epidemiologist and is now appointed as Professor in Implementation of Clinical Practice Guidelines at the department of General Practice of Maastricht University. She is leading one of the research programs of the School for Public Health and Primary Care (Caphri), called "Implementation of Evidence." Her studies are about knowledge transfer; defining and describing quality of care; and improving quality of care through implementation of guidelines and innovations. Her research has a specific focus on the patient perspective and patient participation in medical decision-making where the tension is felt between rationalizing work (the application of guidelines) and patient-centered work (the practice of the consultation). She is visiting senior fellow at Nijmegen IQ Scientific Institute for Quality of Health Care, working with Richard Grol, Netherlands, and at the Cardiff Department of Primary Care and Public Health, working with Glyn Elwyn, UK.



Michel Wensing, PhD
Associate Professor
Radboud University Nijmegen
Medical Centre
Scientific Institute for Quality of Healthcare
Nijmegen, Netherlands

Effective Implementation: Bridging the Gap Between Evidence and Action

Thursday, August 26
2:05 PM - 3:35 PM
Chicago Marriott Downtown, Salon III (7th Floor)

Dr Wensing is a health services researcher with initial training in research sociology at the Scientific Institute for Quality of Healthcare, Radboud University Nijmegen Medical Centre. His research has focused on the implementation of clinical guidelines in primary care. Areas of interests include cardiovascular health, mental health, patient safety, out-of-hours care, practice management, and implementation theories.



Steven H. Woolf, MD, MPH
Director, Virginia Commonwealth
University Center on Human Needs
Professor of Family Medicine,
Epidemiology, and Community
Health
Virginia Commonwealth University
Richmond, VA

Politics, Media, and Guidelines: A Dangerous Mix?

Thursday, August 26
8:00 AM - 10:15 AM
Chicago Marriott Downtown, Salon III (7th Floor)

Dr Woolf received his MD from Emory University and underwent residency training in family medicine at Virginia Commonwealth University. Dr Woolf is also a clinical epidemiologist and underwent training in preventive medicine and public health at Johns Hopkins University, where he received his MPH. He is board-certified in family medicine and in preventive medicine and public health.

Curriculum by Topic

EVIDENCE GENERATION AND SYNTHESIS

THURSDAY, AUGUST 26

10:45 AM - 12:15 PM

Short Oral Presentation:

- Evidence generation and synthesis

4:05 PM - 5:35 PM

Short Oral Presentation:

- Evidence appraisal and synthesis

FRIDAY, AUGUST 27

10:15 AM - 11:45 AM

Workshop:

- A new clinical appropriateness tool for practice guidelines: item generation and refinement

Short Oral Presentation:

- Cost-effectiveness

3:30 PM - 5:00 PM

Workshop:

- Assessing the evidence for diagnostic imaging guidelines: Going beyond accuracy

SATURDAY, AUGUST 28

8:00 AM - 9:30 AM

Workshop:

- Evidence tables III: Prognostic and economic evaluation

GUIDELINE DEVELOPMENT

THURSDAY, AUGUST 26

10:45 AM - 12:15 PM

Workshop:

- Applicability of clinical practice guidelines to patients with comorbid conditions: How to address comorbidity in guidelines
- Critical appraisal instruments for (methodological) search filters for efficient information retrieval for guideline topics

Short Oral Presentation:

- Combining efforts/adapting guidelines
- Patient/family stakeholder roles I
- Turning evidence into recommendations

4:05 PM - 5:35 PM

Workshop:

- Medical societies and G-I-N: A win-win collaboration

Short Oral Presentation:

- Critical topics in guideline development
- Guidelines and patient safety
- Using GRADE

FRIDAY, AUGUST 27

10:15 AM - 11:45 AM

Workshop:

- A quality-driven, pragmatic approach to crafting guideline action statements and evidence profiles
- Cutting across national boundaries: Using the C-section to promote guidance development

Short Oral Presentation:

- Disease-oriented guideline development
- Guideline quality appraisal

3:30 PM - 5:00 PM

Workshop:

- Developing dynamic tobacco control guidelines in Canada

Short Oral Presentation:

- Guidelines for patients
- Guidelines in developing countries
- Updating and archiving guidelines

SATURDAY, AUGUST 28

8:00 AM - 9:30 AM

Short Oral Presentation:

- Ethical issues and conflict of interest
- Guidelines for allied health professionals
- Patient/family stakeholder roles II

GUIDELINE DISSEMINATION

FRIDAY, AUGUST 27

10:15 AM - 11:45 AM

Short Oral Presentation:

- Technology and guideline dissemination

GUIDELINE IMPLEMENTATION

THURSDAY, AUGUST 26

10:45 AM - 12:15 PM

Workshop:

- Primary prevention in primary care: avoid recreating the wheel

Short Oral Presentation:

- Barriers to implementation
- Guidelines and professional education

4:05 PM - 5:35 PM

Workshop:

- Developing quality indicators from clinical guideline recommendations: Learning from the NICE and Duodecim approaches
- Opportunity for guideline developers, implementers and end users to work together to improve guideline implementation

Short Oral Presentation:

- Incorporating guidelines into health-care systems

FRIDAY, AUGUST 27

10:15 AM - 11:45 AM

Short Oral Presentation:

- Implementation approaches

3:30 PM - 5:00 PM

Workshop:

- Getting to the heart of guideline implementation using social marketing approaches

Short Oral Presentation:

- Implementation methods
- Performance measures I

SATURDAY, AUGUST 28

8:00 AM - 9:30 AM

Workshop:

- Breaking the Barrier: Enhancing ACCP guideline implementation in China
- Key measure attributes: Using the National Quality Measures Clearinghouse Template of Measure Attributes to select measures

Short Oral Presentation:

- Computer-based decision support
- Performance measures II



Curriculum by Date

WEDNESDAY, AUGUST 25

8:30 AM - 4:30 PM

Session ID 5931

Preconference Course

Chicago Marriott Downtown, Northwestern/Ohio (6th Floor)

American College of Chest Physicians Guideline Methodology Course

The American College of Chest Physicians (ACCP) Guideline Methodology Course aims to provide an in-depth study of the standardized methodology employed by the ACCP to develop evidence-based clinical practice guidelines. Course topics will include, but are not limited to, the issue of harmonization, performance measure development, conflict of interest, continuing medical education programs, electronic decision support tools, and improved patient outcomes as related to the ACCP's guideline development process. Participants will be provided with templates, algorithms, and written processes that will increase the value of the education opportunity and provide them with useful tools to use in their own guideline development.

Faculty

Sandra Zelman Lewis, PhD, Northbrook, IL, USA

Ian T. Nathanson, MD, FCCP, Maitland, FL, USA

Michael K. Gould, MD, FCCP, La Canada, CA, USA

Daniel R. Ouellette, MD, FCCP, Lake Orion, MI, USA

9:00 AM - 4:00 PM

Session ID 5925

Preconference Course

Chicago Marriott Downtown, Great American I/II (6th Floor)

Guidelines International Network Patient and Public Involvement (G-I-N PUBLIC) Course

The Guidelines International Network Patient and Public Involvement Working Group (G-I-N PUBLIC) has worked since 2007 with guideline organizations, researchers, and patient representatives from around the world to develop practical guidance on how to effectively involve the patient and the public. On August 25, 2010, G-I-N PUBLIC will offer a full-day course targeting guideline organizations that have limited or no experience with patient and public involvement and would like to explore, learn more about, or develop structured involvement methods to support high quality, patient-oriented guidelines.

Faculty

Kay Dickersin, PhD, Baltimore, MD, USA

Gill Gyte, BSc, Poulton-Le-Fulde, United Kingdom

Antoine Boivin, MD, Rouyn-Noranda, QC, Canada

Jane Cowl, BSc, London, United Kingdom

Trudy van der Weijden, Maastricht, Netherlands

Sarah Chalmers, MSc, Manchester, United Kingdom

Carol Sakala, PhD, New York, NY, USA

5:30 PM - 7:00 PM

Session ID 5932

Business Meeting

Chicago Marriott Downtown, Indiana/Iowa (6th Floor)

Annual G-I-N Member (AGM) Meeting

Meeting open to G-I-N Members ONLY

7:30 PM - 9:00 PM

Session ID 5933

Reception

Chicago Marriott Downtown, Chicago Ballroom (5th Floor)

G-I-N Welcoming Reception

All G-I-N Conference 2010 attendees are welcome to attend.

THURSDAY, AUGUST 26

8:00 AM - 10:15 AM

Session ID 5916

Plenary Presentation

Chicago Marriott Downtown, Salon III (7th Floor)

Welcome and plenary session: politics, media and guidelines: A dangerous mix?

Chair Richard Shiffman, MD, Yale University, New Haven, CT, USA
Faculty

Ceci Connolly, Washington, DC, USA

Jennifer J. Padberg, MPH, Arlington, VA, USA

Steven Woolf, MD, Fairfax, VA, USA

10:15 AM - 10:45 AM

Session ID 5934

Miscellaneous

Chicago Marriott Downtown, Salon I/II (7th Floor)

Morning Break

10:45 AM - 12:15 PM

Session ID 5540

Workshop

Chicago Marriott Downtown, Northwestern/Ohio (6th Floor)

Applicability of clinical practice guidelines to patients with comorbid conditions: How to address comorbidity in guidelines (W8)

In the first part of the workshop, we will discuss the applicability of practice guidelines to patients with comorbid conditions by presenting the results from a recently conducted study. A plenary discussion will follow to provide opportunities to share experiences.

In the second part of the workshop, we will present a framework that focuses on the following four areas of comorbidity:

1. Diseases with consistent impact across conditions
2. Most common disease combinations
3. Combinations associated with high disease and resource burden
4. Disease combination with specific clinical problems relating to diagnosis, monitoring, and treatment.

After introduction to the framework, we will explore whether and how the framework might support the work of guideline developers aiming to integrate comorbidity within existing or new guidelines. Interactive exercises will give participants the opportunity to use the framework in different settings and contexts.

Faculty

Marjolein Lugtenberg, MSc, Tilburg University, TRANZO, Tilburg, Netherlands

Klara Brunnhuber, PhD, BMJ Group, London, United Kingdom

James Woodcock, MD, London School of Hygiene and Tropical Medicine, London, United Kingdom

Gert Westert, PhD, Tilburg University, TRANZO, Tilburg, Netherlands

Jako Burgers, PhD, IQ Healthcare, Nijmegen, Netherlands

10:45 AM - 12:15 PM

Session ID 5532

Workshop

Chicago Marriott Downtown, Purdue/Wisconsin (6th Floor)

Critical appraisal instruments for (methodological) search filters for efficient information retrieval for guideline topics (W5)

The workshop will start to discuss possibilities of scoring lists for evaluation of search filters (a list adapted from Sampson 2009 and the pragmatic critical appraisal instrument from Bak 2009). With those lists existing (methodological) search filters that were in use by several guideline organizations in October 2009 will receive a score.

Important criteria are also performance characteristics of the filters. We will discuss what are realistic (in literature also reported) values for sensitivity, specificity, and precision of filters and how the "validation database" of the SEARCH group can provide those performance data for information retrieval specific for guidelines.

Participants will be asked to evaluate the usefulness of the lists as a tool to facilitate in choosing the best search filter. Most information specialists use the PICO(S) (=Patient, Intervention, Comparison, Outcome, Study design) model when building a search strategy.

Critical appraisal of each of those four elements with scoring systems, together with realistic values for sensitivity, specificity, and precision, will help to optimize searching.

Results of this workshop will be summarized and discussed.

Faculty

Rikie Deurenberg, MSc, Dutch Institute for Healthcare Improvement CBO, Utrecht, Netherlands

Marjo Poth, MSc, Dutch Institute for Healthcare Improvement CBO, Utrecht, Netherlands

Leena M. Lodenius, Finnish Medical Society Duodecim, Helsinki, Finland

10:45 AM - 12:15 PM

Session ID 5527

Workshop

Chicago Marriott Downtown, Indiana/Iowa (6th Floor)

Primary prevention in primary care: Avoid recreating the wheel (W13)

This workshop will describe the process by which information across disease areas was selected and integrated into implementation strategies at both practice and patient levels (eg; audit and feedback, computer based decision support and prompts, prevention practitioners, etc). The emphasis was to build from what already exists and to leverage the knowledge of the participating practices to develop effective tool kits and strategies for implementation.

The first step in this process was to review current guideline recommendations and existing tools to determine relevance to the primary care setting and feasibility for uptake. Guidelines published in each clinical area were identified using a very direct search strategy that focused on currency and relevance to the clinical setting. Guidelines were then evaluated using the AGREE domains as a guide in order to

determine which had good rigor of development, editorial independence, and had recommendations that were linked directly to the evidence. Recommendations from the top three to five highest ranking guidelines were extracted along with their levels of evidence. These recommendations were compared to one another and considered within the local context to select the recommendations which would form the basis for our interventions.

Faculty

Jess Rogers, Centre for Effective Practice, Toronto, ON, Canada
Denise Campbell-Scherer, MD, University of Alberta, Edmonton, AB, Canada

10:45 AM - 12:15 PM

Session ID 5669

Short Oral Presentation

Chicago Marriott Downtown, Michigan/Michigan State (6th Floor)

Barriers to implementation

Moderator: Amir Qaseem, MD, PhD, American College of Physicians, Philadelphia, PA, USA

- Critical appraisal of screening mammography guidelines: Why they differ and how this impacts physician guidance and shared decision making with their patients (S88)
Belinda Ireland, MD, Pacific, MO, USA
- Implementation of GLIA Assessment in Kaiser Permanente and NHLBI to improve implementability of recommendations (S89)
Wiley Chan, MD, Kaiser Permanente, Portland, OR, USA
- Promoting evidence-based decision-making in India: District Evaluation Study on Health (DESH) (S103)
Onil Bhattacharyya, Centre for Global Health Research, Toronto, ON, Canada
- Reasons behind non-adherence to pediatric asthma guidelines in emergency department of King Khalid University (S90)
Rasmieh Ayed Al Zeidan, BScPharm, Chair for EBHC & KT, King Saud University, KSA, Al Riyadh, Saudi Arabia

10:45 AM - 12:15 PM

Session ID 5655

Short Oral Presentation

Chicago Marriott Downtown, McHenry (3rd Floor)

Combining efforts/adapting guidelines

Moderator: Rosa Rico-Iturriz, MSc, Basque Office for Health Technology Assessment, Spain

- A model for an international collaboration across organizations for developing clinical practice guidelines (S27)
Holger J. Schunemann, MD, McMaster University, Hamilton, ON, Canada
- Adapting NICE guidance for a developing country: Pilot hypertension project with NICE International in Jordan (S15)
Rachel O Mahony, PhD, NCGC, Royal College of Physicians, London, United Kingdom

- Adapting the ADAPTE Framework (S30)

Ann Scott, PhD, Edmonton, AB, Canada

- Uniform user specifications to improve usability of external systematic reviews and guidelines (S16)

Jeffrey S. Harris, MD, Kaiser Permanente Care Management Institute, Mill Valley, CA, USA

- eAGREE Training Tool: An electronic educational tool designed to improve a learner's performance, satisfaction, and self-efficacy with the AGREE II (S113)

Melissa C. Brouwers, PhD, McMaster University, Hamilton, ON, Canada

10:45 AM - 12:15 PM

Session ID 5631

Short Oral Presentation

Chicago Marriott Downtown, Lincolnshire I/II (6th Floor)

Evidence generation and synthesis

Moderator: Kay Dickersin, PhD, Johns Hopkins, Cochrane Collaborative, Baltimore, MD, USA

- Adopting a realist review approach to conceptualizing the relationship between the perceived characteristics of clinical practice guidelines and their uptake (S8)
Onil Bhattacharyya, St. Michael's Hospital, Toronto, ON, Canada
- Comparison of the quality and amount of guidelines identified by conventional database searches vs. extended systematic search methods (S32)
Daniel Anzola, MD, Bogotá, Colombia
- How well do methodological search filters perform (S40)
Rikie Deurenberg, MSc, Dutch Institute for Healthcare Improvement CBO, Utrecht, Netherlands
- Radiation oncology: Is it time for a clinical practice guideline? The case of PET-CT in treatment planning (S11)
Iñaki Gutiérrez-Ibarluzea, PhD, Osteba, Basque Office for HTA, Vitoria-Gasteiz, Spain
- Validation of a reporting guideline for mixed treatment comparisons (S13)
Stefanie Reken, MSc, National Institute for Health & Clinical Excellence, London, United Kingdom

10:45 AM - 12:15 PM

Session ID 5662

Short Oral Presentation

Chicago Marriott Downtown, Cook (3rd Floor)

Guidelines and professional education

Moderator: Doreen Addrizzo-Harris, MD, FCCP, New York University, School of Medicine, New York, NY, USA

- Guideline Implementation as Interprofessional and systems issues (S124)
Nancy A. Matthew-Maich, PhD (MSc, McMaster University, Mohawk College, Hamilton, ON, Canada)
- How can we improve guideline implementation? Development and evaluation of self-audit tools (S110)
Jessica Cheng, BSc, Toronto General Research Institute, Toronto, ON, Canada
- Rx for Change: Changing professional behavior - An updated overview of systematic reviews (S12)
Julia Worswick, BA, University of Ottawa, Ottawa, ON, Canada
- Understanding potential barriers and facilitators in the implementation of NICE clinical practice guidelines: Results of a survey of United Kingdom medical students (S111)
Logan N. Manikam, MBChB, University of Leicester, Leicester, United Kingdom
- Venous thrombosis prophylaxis in general surgery: Education of medical staff in audit improves compliance with national guidelines (S112)
Jennifer Ross, BSc, Aberdeen Royal Infirmary, Aberdeen, United Kingdom

10:45 AM - 12:15 PM

Session ID 5635

Short Oral Presentation

Chicago Marriott Downtown, Kane (3rd Floor)

Patient/family stakeholder roles I

Moderator: Richard Rosenfeld, MD, MPH, SUNY Downstate Medical Center, Long Island College Hospital, Brooklyn, NY, USA

- "Community members brought real life experience: An evaluation of lay people's contribution to public health guidelines (S69)
Jane Cowl, MSc, National Institute for Health & Clinical Excellence, London, United Kingdom
- Involving decision makers in guidelines research: A case study (S71)
Martin H. Reed, MD, Winnipeg, MB, Canada
- Patient involvement in Germany - How and when? (S73)
Corinna Schaefer, German Agency for Quality in Medicine (ÄZQ), Berlin, Germany
- Patient perspectives in clinical practice guideline (CPG): Participation and qualitative research (S74)
Javier Gracia, Health Technology Assessment Unit, Madrid, Spain
- Patients initiate and lead the Multidisciplinary Guideline for Orofacial Pain (S75)
Marianne van den Berg, PhD, Dutch Headache Patient Organisation, Bunde, Netherlands

10:45 AM - 12:15 PM

Session ID 5637

Short Oral Presentation

Chicago Marriott Downtown, Dupage (3rd Floor)

Turning evidence into recommendations

Moderator: Hyeongsik Ahn, MD, PhD, Korea University, Seoul, South Korea

- A new approach to advice for guideline developers (S64)
Nancy Huang, MPH, NHMRC's National Institute of Clinical Studies, Hampton, VIC, Australia
- Experiences with the application of a tool to structure the process from conclusion to recommendation in a transparent way (S20)
Sonja Kersten, Association of Comprehensive Cancer Centres, Utrecht, Netherlands
- Guiding urology practice: the american urological association's (AUA) new guideline development process (S38)
Heddy Hubbard, PhD, American Urological Association, Linthicum, MD, USA
- How mixed treatment comparisons can aid decision making in guidelines with limited or poor quality evidence (S39)
Katrina L. Sparrow, MSc, National Clinical Guidelines Centre, London, United Kingdom
- Using and adapting GRADE methodology in an area of low quality evidence: An example from a national guideline on ablative therapies for the treatment of Barrett's oesophagus (S22)
Jonathan Nyong, MPH, National Institute for Health and Clinical Excellence, Manchester, United Kingdom

12:15 PM - 1:25 PM

Session ID 5936

Luncheon

Chicago Marriott Downtown, Salon I/II (7th Floor)

Lunch

1:25 PM - 1:55 PM

Session ID 5675

Poster

Chicago Marriott Downtown, Salon I/II (7th Floor)

Poster Session I

Poster Session I Tracks: Evidence generation and synthesis and guideline development



2:05 PM - 3:35 PM

Session ID 5917

Plenary Presentation

Chicago Marriott Downtown, Salon III (7th Floor)

Effective Implementation: Bridging the gap between evidence and action

Chair Susan M. Phillips, PhD, Melbourne, VIC, Australia

Faculty

Martin Eccles, MD, Newcastle Upon Tyne, United Kingdom

Roberto Grilli, MD, Bologna, Italy

Michel J. Wensing, PhD, Nymegen, Netherlands

3:35 PM - 4:05 PM

Session ID 5935

Chicago Marriott Downtown, Salon I/II (7th Floor)

Afternoon Break

4:05 PM - 5:35 PM

Session ID 5537

Workshop

Chicago Marriott Downtown, Indiana/Iowa (6th Floor)

Developing quality indicators from clinical guideline recommendations: Learning from the NICE and Duodecim approaches (W14)

A facilitated interactive workshop will use case studies from NICE and current care to determine the steps that need to be undertaken when developing indicators for clinical guideline recommendations. These steps will include the selection and prioritization of clinical guideline recommendations for indicator development, operationalization of the indicator, including the development of the wording of the indicator, and piloting of the draft indicator. These steps will be discussed in terms of their effect on the quality of the indicator (its validity, acceptability, and feasibility).

Faculty

Tim Stokes, MBChB, NICE, Manchester, United Kingdom

Raija Sipilä, MD, Finnish Medical Society - Duodecim, Helsinki, Finland

Eeva Ketola, MD, Finnish Medical Society - Duodecim, Helsinki, Finland

4:05 PM - 5:35 PM

Session ID 5531

Workshop

Chicago Marriott Downtown, Northwestern/Ohio (6th Floor)

Medical societies and G-I-N: A win-win collaboration (W4)

This invited parallel session will explore opportunities for successful collaboration between G-I-N and medical societies. The target audience is members and staff of medical societies interested in learning how involvement with G-I-N can improve their ability to develop, implement, and assess guidelines of relevance to their membership.

David Nielsen, EVP and CEO of the AAO-HNS, will describe how a society with limited guideline experience developed a thriving program through effective collaboration with G-I-N and the Cochrane Collaboration. Conversely, David Gutterman, MD, FCCP, President-Elect of the ACCP, will demonstrate how a society with a well-established guideline program can work with G-I-N to improve and streamline their processes.

The needs, in general, of medical specialty societies relating to guideline development will be discussed by Norman Kahn, EVP and CEO of the CMSS. A critical priority of CMSS, which includes more than 40 members, is to help specialty societies migrate to a culture of quality improvement and performance measurement. In this regard, Jako Burgers, past chair of the G-I-N board of trustees, will summarize how G-I-N can help medical societies with guideline development and how the societies can assist G-I-N. Time is allotted for audience questions.

Faculty

Richard Rosenfeld, MD, Amer Acad Otolaryngology - Head & Neck Surgery, Brooklyn, NY, USA

David Nielsen, MD, Amer Acad Otolaryngology - Head & Neck Surgery, Alexandria, VA, USA

Norman Kahn, MD, Council of Medical Specialty Societies, Chicago, IL, USA

David D. Gutterman, MD, FCCP, Medical College of Wisconsin, Milwaukee, WI, USA

Jako Burgers, PhD, Dutch Institute for Healthcare Improvement CBO, Nijmegen, Netherlands

4:05 PM - 5:35 PM

Session ID 5535

Workshop

Chicago Marriott Downtown, Purdue/Wisconsin (6th Floor)

Opportunity for guideline developers, implementers and end users to work together to improve guideline implementation (W11)

Presenters will provide background information on developers' efforts to use participatory approaches to guideline development and a summary of guideline implementation research, theories of change, and specific examples.

Participants will be invited to break into smaller groups and to focus on what can be done during the guideline development process to increase the likelihood of implementation. Participants will be asked to explore factors such as those identified in GLIA but will also be encouraged to focus on other possible strategies, such as the following: collaborative and participatory approaches to guideline development; and greater involvement of end users at different stages of the development process; post-implementation review of guideline development.

Faculty

Susan M. Phillips, PhD, NHMRC's National Institute of Clinical Studies, Melbourne, VIC, Australia

Susan Huckson, NHMRC's National Institute of Clinical Studies, Melbourne, VIC, Australia

Ian Graham, PhD, Canadian Institutes of Health Research, Ottawa, ON, Canada

4:05 PM - 5:35 PM

Session ID 5648

Short Oral Presentation

Chicago Marriott Downtown, Michigan/Michigan State (6th Floor)

Critical topics in guideline development

Moderator: Virginia Moyer, MD, MPH, Texas Children's Hospital, Baylor College of Medicine, Houston, TX, USA

- A framework to improve guidelines for patients with multimorbidity (S59)
Cynthia Boyd, MD, Johns Hopkins, Towson, MD, USA
- Rapid development and implementation of guidelines for infant neuroprotection with antenatal magnesium sulphate (MgSO₄) (S44)
Philippa F. Middleton, The University of Adelaide, North Adelaide, S A, Australia
- The network guideline: A new model of developing a multidisciplinary guideline (S47)
Tjerk Wiersma, MD, Dutch College of General Practitioners, Utrecht, Netherlands
- "Less is more": The minimal dataset in reviews for guidelines (S48)
Maggie Westby, PhD, National Clinical Guideline Centre, London, United Kingdom
- The network approach: A feasible method in clinical guideline development (S49)
Elvira M.E. Den Breejen, MD, Radboud University Medical Center Nijmegen, Nijmegen, Netherlands

4:05 PM - 5:35 PM

Session ID 5632

Short Oral Presentation

Chicago Marriott Downtown, McHenry (3rd Floor)

Evidence appraisal and synthesis

Moderator: Hyeongsik Ahn, MD, PhD, Korea University, Seoul, South Korea

- Diagnosis: Interpreting evidence in the absence of a reference standard - Two case studies from national guidelines (S4)
Alfred W. Sackeyfio, NICE, Manchester, United Kingdom
- Generalizability of results from randomized trials: A systematic overview of possible approaches (S5)
Piet N. Post, PhD, Dutch Institute for Healthcare Improvement CBO, Utrecht, Netherlands
- GRADE: adaptation of GRADE evidence profiles to different evidence types: A case study of NICE motor neurone disease—Noninvasive ventilation guideline (S9)
Faisal Siddiqui, MSc, NICE, Manchester, United Kingdom
- GRADE: presentation of evidence profiles in clinical guidelines (S10)
Faisal Siddiqui, MSc, NICE, Manchester, United Kingdom
- Validation and modification of the Graphical Appraisal Tool for Epidemiology (GATE) for appraising studies in evidence-based guideline development (S6)
Anita Fitzgerald, New Zealand Guidelines Group, Auckland, New Zealand

4:05 PM - 5:35 PM

Session ID 5642

Short Oral Presentation

Chicago Marriott Downtown, Cook (3rd Floor)

Guidelines and patient safety

Moderator: Janet Maurer, MD, FCCP, Health Dialog, Desert Hills, AZ, USA

- Developing a systematic approach to link CPG and patient safety (S50)
Ignacio Marin-Leon, PhD, Valme University Hospital. Fundacion Enebro, Seville, Spain
- Developing patient safety evidence-based care Recommendations to improve child outcomes (S51)
Karen J. Vonderhaar, MS, Cincinnati Children's Hospital Medical Center, Cincinnati, OH, USA



4:05 PM - 5:35 PM

Session ID 5665

Short Oral Presentation

Chicago Marriott Downtown, Kane (3rd Floor)

Incorporating guidelines into healthcare systems

Moderator: Doreen Addrizzo-Harris, MD, FCCP, New York University, School of Medicine, New York, NY, USA

- A system-wide model for delivering critical care facilitated long-term successful guideline implementations (S104)
Richard S. Irwin, MD, UMass Memorial Medical Center, Worcester, MA, USA
- An integrated approach to developing health-care guidelines (S28)
Kathy Cummings, MA, Institute for Clinical Systems Improvement, Bloomington, MN, USA
- Are we making the most of disinvestment opportunities? (S105)
Caroline A. Keir, MSc, NICE, London, United Kingdom
- Embedding guidance into electronic medical records and panel management tools: implications for guideline writers (S107)
Wiley Chan, MD, Kaiser Permanente, Portland, OR, USA
- Implementation of the Guidelines for the Diagnosis and Management of Asthma, 2007 (Guidelines) in Suffolk County, New York operated health centers (SCHCs) (S108)
Lewis R. Mooney, MD, Suffolk County (NY) Dept. of Health Services, Coram, NY, USA

4:05 PM - 5:35 PM

Session ID 5656

Short Oral Presentation

Chicago Marriott Downtown, Lincolnshire I/II (6th Floor)

Using GRADE

Moderator: Amir Qaseem, MD, PhD, American College of Physicians, Philadelphia, PA, USA

- Attitudes of guideline development groups to use of GRADE in evidence evaluation and development of recommendations (S29)
Victoria J. Kelly, National Institute Health and Clinical Excellence, Manchester, United Kingdom
- Experiences Presenting GRADE to the Guideline Development Group on the NICE Lower Urinary Tract Symptoms (LUTS) Guideline (S36)
Clare N. Jones, MSc, National Clinical Guideline Centre, London, England, United Kingdom
- GRADE Imprecision Criteria: Interpretation and Impact on the NICE Lower Urinary Tract Symptoms in Men Guideline (S37)
Lee-Yee Chong, PhD, National Clinical Guidelines Centre (NCGC), London, United Kingdom

- Implementing GRADE in an established national guideline program (S21)

Robin T. Harbour, BSc, Scottish Intercollegiate Guidelines network, Glasgow, Scotland, United Kingdom

- Using the GRADE approach to develop diagnostic guidelines in allergic disease: The World Allergy Organization's Diagnosis and Rationale for Action against Cow Milk Allergy (DRACMA) Guidelines (S14)

Airton Tetelbom Stein, MD, Public Health of UFCSPA, Ulbra, Conceicao Hospital, Porto Alegre, Brazil

5:45 PM - 7:15 PM

Session ID 5943

Business Meeting

Chicago Marriott Downtown, Indiana/Iowa (6th Floor)

United States G-I-N Interest Group

All G-I-N Conference 2010 attendees are invited to participate in an exploratory meeting for the G-I-N United States interest group.

Goals of the interest group might include:

1. Discussing regional issues in the United States related to guideline development
2. Identifying and sharing best practices
3. Improving communication among guideline developers in the United States
4. Creating win-win relationships with G-I-N and the international community
5. Developing strategies to share resources and adapt existing guidelines

This exploratory meeting is open to all who wish to contribute but individuals and groups in the following categories may find the group of particular interest:

- Professional medical associations with an interest in guideline development
- Governmental agencies that support or coordinate guideline activities
- Individuals seeking to enhance personal or organizational guideline efforts
- United States attendees interested in new ideas and collaborative opportunities
- International attendees wishing to share insights and experience

FRIDAY, AUGUST 27

8:00 AM - 9:45 AM

Session ID 5918

Plenary Presentation

Chicago Marriott Downtown, Salon III (7th Floor)

Challenges in managing conflict of interest in guideline development

Chair *Dave Davis, MD, Washington, DC, USA*

Faculty

Catherine DeAngelis, MD, Chicago, IL, USA

Marjukka Makela, Helsinki, Finland

Joel Moss, PhD, Bethesda, MD, USA

9:45 AM - 10:15 AM

Session ID 5937

Chicago Marriott Downtown, Salon I/II (7th Floor)

Morning Break

10:15 AM - 11:45 AM

Session ID 5539

Workshop

Chicago Marriott Downtown, Purdue/Wisconsin

A new clinical appropriateness tool for practice guidelines: item generation and refinement (W3)

Objectives of workshop:

- to review the Research Team's systematic review on the topic of CA
- to create a foundation to develop a refined operational definition
- to refine a list of candidate items that reflect the concept of CA.

Participants will be presented with results of the systematic review, which will answer the following: (1) What are the labels and definitions used to capture the concept of CA of recommendations? and (2) What are the defining features that characterize the concept of CA? Through a structured approach, participants will be asked their agreement on the definitions and concepts that emerged, how they should be refined, other concepts deemed important that were not captured in the systematic review, and a review of a candidate list of tool items.

Faculty

Melissa C. Brouwers, PhD, McMaster University, Hamilton, ON, Canada

Julie Makarski, BSc, McMaster University, Hamilton, ON, Canada

Lisa Durocher, MSc, McMaster University, Hamilton, ON, Canada

10:15 AM - 11:45 AM

Session ID 5538

Workshop

Chicago Marriott Downtown, Indiana/Iowa (6th Floor)

A quality-driven, pragmatic approach to crafting guideline action statements and evidence profiles (W9)

The panel (attendees) will create a miniguide on "Management of the Common Cold" by identifying quality improvement opportunities, drafting a topic list, prioritizing the topics, drafting key action statements from the topics, and assigning fictitious evidence profiles that will be used in determining recommendation strength for each statement. Emphasis is placed on creating clear, actionable statements to facilitate implementation. Attendees will receive a complete Guideline Development Manual, which thoroughly describes and illustrates principles developed in the workshop, plus a sample clinical practice guideline that was created using the suggested approach.

Faculty

Richard Rosenfeld, MD, American Academy of Otolaryngology - H&N Surg, Brooklyn, NY, USA

Richard Shiffman, MD, Yale University, New Haven, CT, USA

10:15 AM - 11:45 AM

Session ID 5530

Workshop

Chicago Marriott Downtown, Northwestern/Ohio (6th Floor)

Cutting across national boundaries: Using the C-section to promote guidance development (W6)

This highly interactive workshop will be split into three parts: (1) An introduction to NICE International and the project with Turkey, highlighting, from NICE's perspective, the technical, linguistic, and cultural challenges, and the fresh perspectives it has brought for us; (2) How are different health care systems influenced by local issues? A discussion of how these issues impact on guideline development and implementation; (3) Evidence-based textbook or evidence-based encyclopaedia? A discussion of how guideline development might become more focused around answering a given set of clinical questions, rather than attempting to evaluate a certain clinical condition.

Faculty

Craig J. Whittington, PhD, National Collaborating Centre for Mental Health, London, United Kingdom

Seda Usubatun, MD, Ankara, Turkey

10:15 AM - 11:45 AM

Session ID 5633

Short Oral Presentation

Chicago Marriott Downtown, Lincolnshire I/II (6th Floor)

Cost-effectiveness

Moderator: Amir Qaseem, MD, PhD, American College of Physicians, Philadelphia, PA, USA

- An evaluation of pathway modelling to assess cost effectiveness in guidelines (S1)
Kim Jeong, NICE, London, United Kingdom
- Combining GRADE, patient reported outcomes and costs in the NICE Lower Urinary Tract Symptoms (LUTS) Guideline (S2)
Elisabetta Fenu, MSc, National Clinical Guidelines Centre, London, England, United Kingdom
- Cost-effectiveness of the fecal occult blood test (FOBT) for colorectal cancer screening in Colombia (S3)
Daniel Anzola, MD, Instituto Nacional de Cancerologia, Bogotá, Colombia
- Incorporating cost effectiveness into guidelines using GRADE-like evidence profiles (S63)
Laura Sawyer, MSc, National Clinical Guidelines Centre, London, United Kingdom

10:15 AM - 11:45 AM

Session ID 5649

Short Oral Presentation

Chicago Marriott Downtown, Dupage (3rd Floor)

Disease-oriented guideline development

Moderator: Daniel R. Ouellette, MD, FCCP, Henry Ford Hospital, Detroit, MI, USA

- Balance@Work: A combined guideline and research project on prevention of weight gain among employees (S31)
Carel Hulshof, PhD, Centre of Excellence, NVAB, Utrecht, Netherlands
- Development and institutionalization of disease management guidelines in Germany (S33)
Thomas Langer, Agency for Quality in Medicine (AquMed), Berlin, Germany
- KP Integrated cardiovascular disease (cvd) risk reduction guidelines (S42)
Craig Robbins, MD, Care Management Institute, Kaiser Permanente, Dever, OR, USA
- The development of recommendations for optimal organization of care in Parkinson's disease (S46)
Samyra HJ Keus, PhD, Radboud University Nijmegen Medical Center, Nijmegen, Netherlands

10:15 AM - 11:45 AM

Session ID 5651

Short Oral Presentation

Chicago Marriott Downtown, McHenry (3rd Floor)

Guideline quality appraisal

Moderator: Virginia Moyer, MD, MPH, Texas Children's Hospital, Baylor College of Medicine, Houston, TX, USA

- An experience using AGREE (S23)
Mohd Aminuddin Mohd.Yusof, MPH, Ministry of Health Malaysia, Putrajaya, Malaysia
- Compatibility of AGREE and clinical experts review in guideline appraisal (S24)
Ken N. Kuo, MD, National Health Research Institutes, Taiwan, Miaoli County, Taiwan ROC
- How to develop new methods for systematic evaluation of internal validity of CPG recommendations (S26)
Michaela Eikermann, MD, IQWiG, Cologne, Germany
- Just finished developing a guideline: how did we do? A process evaluation (S41)
Christa Harstall, MHSA, Institute of Health Economics, Edmonton, AB, Canada

10:15 AM - 11:45 AM

Session ID 5666

Short Oral Presentation

Chicago Marriott Downtown, Kane (3rd Floor)

Implementation approaches

Moderator: Ian T. Nathanson, MD, FCCP, Orlando, FL, USA

- A Government policy approach to implementing a SIGN guideline (S96)
Ali El-Ghorr, PhD, Scottish Intercollegiate Guidelines Network (SIGN), Edinburgh, Scotland, United Kingdom
- An alternative approach to guidelines and quality measurement for older adults with multiple morbidities (S102)
Murray N. Ross, PhD, Kaiser Permanente Institute for Health Policy, Oakland, CA, USA
- Application of a "bundle of care" approach to prioritize guideline recommendations for implementation (S97)
Susan Huckson, BSc, NHMRC's National Institute of Clinical Studies, Melbourne, VIC, Australia
- Implementation of a shared care guideline for back pain: effects on unnecessary referrals and diagnostic procedure (S99)
Margot Ah Fleuren, PhD, TNO Quality of Life, Leiden, Netherlands

10:15 AM - 11:45 AM

Session ID 5657

Short Oral Presentation

Chicago Marriott Downtown, Michigan/Michigan State (6th Floor)

Technology and guideline dissemination

Moderator: Val Moore, MSc, National Institute for Health and Clinical Excellence (NICE), London, England, UK

- Applying the Guideline Elements Model (GEM) Cutter II Tool to guidelines represented in the National Guideline Clearinghouse (www.guideline.gov) (S92)
Lisa T. Haskell, MS, ECRI Institute, Plymouth Meeting, PA, USA
- Communities of practice and information technologies: the perfect duo for optimal knowledge uptake (S82)
Lise Poissant, PhD, University of Montreal, Montreal, QC, Canada
- Dissemination and Implementation of low back pain guidelines: an integrated knowledge transfer approach (S83)
Donna K. Angus, MS, Alberta Innovates - Health Solutions, Edmonton, AB, Canada
- Electronic dissemination of US HIV treatment guideline as a living document: Free access for a global audience (S84)
Alice K. Pau, PharmD, National Institutes of Health, Bethesda, MD, USA
- Using audiovisual patient recordings to promote guideline adherence. (S85)
Holger Wahl, Germany

11:45 AM - 12:50 PM

Session ID 5938

Luncheon

Chicago Marriott Downtown, Salon I/II (7th Floor)

Lunch

12:50 PM - 1:20 PM

Session ID 5677

Poster

Chicago Marriott Downtown, Salon I/II (7th Floor)

Poster Session II

Poster Session II Tracks: Guideline Dissemination & Guideline Implementation

1:30 PM - 3:00 PM

Session ID 5919

Plenary Presentation

Chicago Marriott Downtown, Salon III (7th Floor)

A seat at the table: The effects of consumer engagement in guideline development

Chair Catherine Marshall, Waipukurau, New Zealand Faculty

Kay Dickersin, PhD, Baltimore, MD, USA

Ted Ganiats, MD, La Jolla, CA, USA

Gill Gyte, BSc, Poulton-Le-Fulde, United Kingdom

Trudy van der Weijden, Maastricht, Netherlands

3:00 PM - 3:30 PM

Session ID 5939

Chicago Marriott Downtown, Salon I/II (7th Floor)

Afternoon Break

3:30 PM - 5:00 PM

Session ID 5526

Workshop

Chicago Marriott Downtown, Northwestern/Ohio (6th Floor)

Assessing the evidence for diagnostic imaging guidelines: going beyond accuracy (W1)

The workshop will begin with an introductory talk describing the hierarchical model of diagnostic imaging efficacy and discussing the importance of assessing diagnostic imaging at levels beyond accuracy. Case studies of assessing diagnostic imaging efficacy will then be used to involve the participants in a discussion of methods of assessing diagnostic imaging beyond the level of accuracy.

Faculty

Martin H. Reed, MD, Winnipeg, MB, Canada

3:30 PM - 5:00 PM

Session ID 5528

Workshop

Chicago Marriott Downtown, Purdue/Wisconsin (6th Floor)

Developing dynamic tobacco control guidelines in Canada (W7)

Participants will be introduced to the process CAN-ADAPTT used to develop a national set of clinical practice guidelines (CPGs). This involved systematically searching and compiling existing guidelines on tobacco control followed by using the AGREE instrument to determine the highest-scoring CPGs. User feedback was then incorporated through review cycles, creating guidelines applicable to multiple contexts and responsive to the needs of diverse target users.

The dynamic nature of these guidelines is facilitated through the creation of a Practice-Based Research Network (PBRN), where users define and frame research questions informed by their practices. Seed grants were offered for the pursuit of research in treating tobacco; an online platform was created to ensure the guidelines are reflective of the real needs of its users; and a discussion board encourages input from practitioners and knowledge exchange among PBRN members.

Interactive discussion will focus on engagement of users throughout the guideline development and dissemination process.

Faculty

Peter Selby, MBBS, Centre for Addiction and Mental Health -CAN-ADAPTT, Toronto, ON, Canada

3:30 PM - 5:00 PM

Session ID 5533

Workshop

Chicago Marriott Downtown, Indiana/Iowa (6th Floor)

Getting to the heart of guideline implementation using social marketing approaches (W12)

Case studies from a New Zealand cardiovascular guideline implementation project will be used to introduce interactive exercises.

Participants will take part in an interactive workshop experience that provides opportunities for them to incorporate social marketing techniques into their guideline implementation projects.

Faculty

*Catherine Marshall, Independent Guideline Adviser, Waipukurau, New Zealand
Marama Parore, NZ Pharmaceutical Management Agency, Wellington, New Zealand*

3:30 PM - 5:00 PM

Session ID 5640

Short Oral Presentation

Chicago Marriott Downtown, Cook (3rd Floor)

Guidelines for patients

Moderator: Kay Dickersin, PhD, Johns Hopkins, Cochrane Collaborative, Baltimore, MD, USA

- Cancer survivorship plan in the Netherlands: A guideline for professionals in the oncology (S65)
Sonja Kersten, MSc, Association of Comprehensive Cancer Centres, Utrecht, Netherlands
- Developing patients' versions: the experience from a clinical practice guideline (CPG) for autistic spectrum disorders (ASD) (S56)
Javier Gracia, Health Technology Assessment Unit, Madrid, Spain
- Low back interventions and opioid treatment guidelines: Comparison between ACOEM and APS (S43)
Christopher J. Wolfkiel, ACOEM, Elk Grove Village, IL, USA
- Patient guidelines in oncology: A comparison of international standards and methodologies (S57)
Markus Follmann, MD, German Cancer Society, Berlin, Germany
- The role of patients, family and stakeholders in guideline development: Meta-ethnography of qualitative research on peer support in chronic disease (S58)
Mary J. Bell, MD, Sunnybrook Health Sciences Centre, Toronto, ON, Canada

3:30 PM - 5:00 PM

Session ID 5639

Short Oral Presentation

Chicago Marriott Downtown, McHenry (3rd Floor)

Guidelines in developing countries

Moderator: Hyeongsik Ahn, MD, PhD, Korea University, Seoul, South Korea

- Clinical practice guidelines production and its correlation with developmental status of countries: Analysis in Iberoamerican countries (S60)
Iñaki Gutiérrez-Ibarluzea, PhD, Osteba Basque Office for HTA, Vitoria-Gasteiz, Spain
- Elaboration of a topic prioritization instrument for the development of clinical practice guidelines (CPGs) in Colombia (S35)
Ricardo Sanchez, MD, Instituto Nacional de Cancerología - UNAL, Bogotá, Colombia
- From evidence to practice in countries where health policy is not evidence-based (S7)
Hayfaa A. Wahabi, MBBS, Al Riyadh, Saudi Arabia
- Transnational collaboration in developing ADAPTE clinical guidelines and use of GRADE when making recommendations: Experiences from Costa Rica, Panama and Guatemala. (S61)
Mario G. Tristan, MD, IHCAI Foundation- Central America Cochrane Branch-, San Jose, Costa Rica

3:30 PM - 5:00 PM

Session ID 5667

Short Oral Presentation

Chicago Marriott Downtown, Kane (3rd Floor)

Implementation methods

Moderator: Rosa Rico-Iturrioz, MSc, Basque Office for Health Technology Assessment, Spain

- How can we improve guideline implementation? A systematic review of the role and impact of facilitative intermediaries (S98)
Anna R. Gagliardi, PhD, University Health Network, Toronto, ON, Canada
- Setting priorities in clinical research: Identification and classification of research gaps from evidence-based guidelines (S101)
Ian J. Saldanha, MPH, Johns Hopkins University, Baltimore, MD, USA
- The development of a guideline implementability tool (GUIDE-IT) to facilitate the use of canadian cardiovascular guidelines (S45)
Monika Kastner, Toronto, ON, Canada
- The map of medicine's editorial methodology: How we use CPGs to make our care pathways (S115)
Gajan Srikanthan, MBBS, Map of Medicine, London, England, United Kingdom
- The impact of education, audit, and feedback on improving sepsis care guideline adherence (S95)
Ruth M. Kleinpell, PhD, Rush University Medical Center, Chicago, IL, USA

3:30 PM - 5:00 PM

Session ID 5660

Short Oral Presentation

Chicago Marriott Downtown, Lincolnshire I/II (6th Floor)

Performance measures I

Moderator: Janet Maurer, MD, FCCP, Health Dialog, Desert Hills, AZ, USA

- Comparison of different methods when aggregating quality indicators issued from guidelines in acute myocardial infarction (S116)
Sophie Guerin, COMPAQH project, Villejuif, France
- Development of quality indicators based on clinical practice guidelines: An example with the process of care in breast cancer (S118)
Marie Ferrua, Inserm - Projet Compaqh, Villejuif, France
- From clinical guidelines to pay for performance in UK family practice: The NICE Quality and Outcomes Framework Indicator Program (S119)
Tim Stokes, MBChB, NICE, Manchester, United Kingdom
- Implementing guidelines using the Collaborative Method: The example of the depression guidelines implementation project in the Netherlands (S120)
Gerdien Franx, MSc, Trimbos-institute, Utrecht, Netherlands
- Quality Indicators (QI) in German evidence-based guidelines (S121)
Monika Nothacker, MD, Agency for Quality in Medicine (ÄZQ), Berlin, Germany

3:30 PM - 5:00 PM

Session ID 5634

Short Oral Presentation

Chicago Marriott Downtown, Michigan/Michigan State (6th Floor)

Updating and archiving guidelines

Moderator: Richard Rosenfeld, MD, MPH, SUNY Downstate Medical Center, Long Island College Hospital, Brooklyn, NY, USA

- Analysis of chronic respiratory disease guideline updates of the past 10 years (S78)
Liat Fishman, MD, German Agency for Quality in Medicine, Berlin, Germany
- Development of revised recommendations for hiv counseling, testing, and linkage in non-health-care settings (S34)
Rebecca L. Morgan, MPH, Centers for Disease Control and Prevention, Atlanta, GA, USA
- Inventory of cancer guidelines: An approach for guideline dissemination, quality appraisal and information sharing (S80)
Melissa C. Brouwers, PhD, McMaster University, Hamilton, ON, Canada
- Occupational medicine guidelines mandated by states: Experience with state rule making and regulatory agencies (S81)
Christopher J. Wolfkiel, ACOEM, Elk Grove Village, IL, USA

6:00 PM - 11:00 PM

Session ID 5940

Special Event

Navy Pier, Chicago, IL

G-I-N Gala Event: Odyssey II Sunset Dinner Cruise

Trolley pick-up Details:

Pick-up times: 6:00 PM – 7:00 PM

Pick-up location: Chicago Marriot Downtown (Rush Street Entrance)

SATURDAY, AUGUST 28

8:00 AM - 9:30 AM

Session ID 5536

Workshop

Chicago Marriott Downtown, Northwestern/Ohio (6th Floor)

Breaking the barrier: Enhancing ACCP guideline implementation in China (W10)

We will describe unique features in the styles of clinical practice in China and how these cultural differences impede Western guideline implementation. We will introduce our effort in promoting ACCP guidelines implementation and ACCP impacts in China. We will appeal to GIN to join our effort.

Faculty

Renli Qiao, MD, FCCP, University of Southern California, Los Angeles, CA, USA

8:00 AM - 9:30 AM

Session ID 5529

Workshop

Chicago Marriott Downtown, Purdue/Wisconsin (6th Floor)

Evidence tables III: Prognostic and economic evaluation (W2)

Short description of the workshop.

This workshop will present the survey of current templates on prognostic and economic evaluation used by GIN members; and a literature search on standards/ formats for prognostic and economic evaluation.

The presentations will be followed by a discussion of these results.

The expected outcomes from the workshop are the following:

- present and discuss the results;
- receive the attendees' feedback on it;
- improve participants' understanding of what is required in a minimum data set for summarizing these studies; and
- take forward the work in defining a potential list of items to be included in each template (ie, prognostic, economic evaluations).

This workshop will be of most interest for guidelines or HTA developers, researchers dealing with literature reviews and concerned by evidence-based health care.

Faculty

Najoua Mlika-Cabanne, MD, Haute Autorité de santé (HAS), Saint Denis La Plaine, France

Robin T. Harbour, BSc, Scottish Intercollegiate Guidelines Network (SIGN), Glasgow, Scotland, United Kingdom

Hans de Beer, MD, Dutch Institute for Healthcare Improvement (CBO), Best, Netherlands

Robert Cook, MBBS, Bazian Ltd, London, United Kingdom

Sara Twaddle, PhD, Scottish Intercollegiate Guidelines Network (SIGN), Edinburgh, United Kingdom

8:00 AM - 9:30 AM

Session ID 5534

Workshop

Chicago Marriott Downtown, Indiana/Iowa (6th Floor)

Key measure attributes: Using the National Quality Measures Clearinghouse Template of Measure Attributes to select measures (W15)

This workshop will demonstrate how certain key measure attributes in the NQMC template may be used to evaluate the validity of a measure for an intended purpose. Use-case scenarios will be presented to allow the attendees to work through specific examples.

Faculty

Mark Monteforte, MD, ECRI Institute, Plymouth Meeting, PA, USA

Melanie Swan, MPH, ECRI Institute, Plymouth Meeting, PA, USA

Vivian Coates, MBA, ECRI Institute, Plymouth Meeting, PA, USA

Mary Nix, MS, Agency for Healthcare Research and Quality, Rockville, MD, USA

8:00 AM - 9:30 AM

Session ID 5668

Short Oral Presentation

Chicago Marriott Downtown, Lincolnshire I/II (6th Floor)

Computer-based decision support

Moderator: Richard Shiffman, MD, Yale University, New Haven, CT, USA

- Actionable point-of-care decision support in multiple languages (S91)
Ilkka Kunnamo, MD, Duodecim Medical Publications Ltd., Karstula, Finland
- Diliguide: A Web-based tool for guideline development and implementation (S67)
Danielle Sent, PhD, Dutch Institute for Healthcare Improvement, Utrecht, Netherlands
- Recommendations for clinical guideline developers regarding clinical decision support-related standards (S94)
Dean F. Sittig, PhD, University of Texas, Houston, Houston, TX, USA
- Web-based adjuncts to guideline dissemination: Novel interventions from the Scottish Intercollegiate Guidelines Network (SIGN) (S86)
Sara Twaddle, PhD, SIGN, Edinburgh, United Kingdom

8:00 AM - 9:30 AM

Session ID 5652

Short Oral Presentation

Chicago Marriott Downtown, Michigan/Michigan State
(6th Floor)

Ethical issues and conflict of interest

Moderator: Ian T. Nathanson, MD, FCCP, Orlando, FL, USA

- Conflicts of interest: What to do when things go wrong: A case study. (S17)
Rosina M. Ullman, PhD, NCC Women's and Children's Health, Sutton, England, United Kingdom
- Ethical aspects in CPGs: Explicit or implicit (S25)
Radim Licenik, MD, University Hospital of North Staffordshire, Stoke on Trent, United Kingdom
- Ethics and guidelines, ethics in guidelines? Ethical chapters in CPGs on dilemmas in work and health (S68)
Arnolda Petra Nauta, PhD, The Netherlands Society of Occupational Medicine, Delft, Netherlands
- Gender analysis of clinical practice guidelines for depression from four European countries: Austria, Finland, Sweden, and the United Kingdom (S19)
Susanne Weinbrenner, MD, German Agency for Quality in Medicine, Berlin, Germany
- The vexing problem of guidelines and conflict of interest: A potential solution (S18)
Holger J. Schunemann, MD, McMaster University, Hamilton, ON, Canada

8:00 AM - 9:30 AM

Session ID 5641

Short Oral Presentation

Chicago Marriott Downtown, Cook (3rd Floor)

Guidelines for allied health professionals

Moderator: Eeva Ketola, MD, PhD, Current Care – Finnish Medical Society Duodecium, Helsinki, Finland

- Challenges to developing guidelines for a public dental service (S53)
Carmel Parnell, MPH, Oral Health Services Research Centre, Cork, Ireland
- Development of Pharmacist-specific Diabetes Guidelines (S54)
Rosemary M. Killeen, BScPharm, Canadian Pharmacists Journal, Ottawa, ON, Canada
- Involving stakeholders in developing multidisciplinary and cross-sectoral clinical practice guidelines in social services (S55)
Jean-Pierre Duplantie, DrPH, AETMIS, Montreal, QC, Canada

8:00 AM - 9:30 AM

Session ID 5636

Short Oral Presentation

Chicago Marriott Downtown, Kane (3rd Floor)

Patient/family stakeholder roles II

Moderator: Richard Rosenfeld, MD, MPH, SUNY Downstate Medical Center, Long Island College Hospital, Brooklyn, NY, USA

- Consumer involvement in guideline development: early stage chronic kidney disease (S70)
Allison Tong, PhD, University of Sydney, Sydney, NSW, Australia
- Stakeholder engagement in the scoping phase of clinical guideline development: Challenges and solutions (S76)
Nichole Tasker, PhD, NICE, London, United Kingdom
- Standardization of patient participation in guideline development (S77)
Ilse Raats, PhD, Dutch Institute for Healthcare Improvement CBO, Utrecht, Netherlands
- Lessons for optimization of patient participation in guideline development: an action research approach (S72)
Alida van der Ham, MSc, VU University Amsterdam, Amsterdam, Netherlands

8:00 AM - 9:30 AM

Session ID 5661

Short Oral Presentation

Chicago Marriott Downtown, McHenry (3rd Floor)

Performance measures II

Moderator: Janet Maurer, MD, FCCP, Health Dialog, Desert Hills, AZ, USA

- Developing quality standards for the NHS in England: The NICE Quality Standards Program (S106)
Tim Stokes, MBChB, NICE, Manchester, United Kingdom
- Development of guideline-based quality indicators for postpartum hemorrhage (PPH) to improve quality of care (S117)
Mallory D. Woiski, MD, Radboud University Nijmegen, Nijmegen, Netherlands
- Rationalized perioperative antibiotic prophylaxis through Incorporation of Scottish Intercollegiate Guideline Network (SIGN) Guidelines with local practice (S109)
Terry O'Kelly, MD, Aberdeen Royal Infirmary, Aberdeen, United Kingdom
- Standardizing criteria for use of guidelines in performance measures development (S122)
Mark S. Antman, DDS, American Medical Association, Chicago, IL, USA
- Target for improvement: Integrating public, professionals, and managers' perspectives in quality indicator prioritization (S123)
Antoine Boivin, MD, Scientific Institute for Quality of Healthcare, Rouyn-Noranda, QC, Canada



9:30 AM - 10:00 AM

Session ID 5941

Chicago Marriott Downtown, 7th Floor Registration

Morning Break

10:00 AM - 12:00 PM

Session ID 5920

Plenary Presentation

Chicago Marriott Downtown, Salon III (7th Floor)

Closing remarks and plenary session: Rationing or rationality? Health economics in national guidance

Chair Guenter Ollenschlaeger, MD, Berlin, Germany

• G-I-N Conference 2011 Introduction

Hyeongsik Ahn, MD, PhD, Korea University, Seoul, South Korea

Faculty

Fergus MacBeth, MA, London, England, United Kingdom

Finn B. Kristensen, MD, Copenhagen, Denmark

Poster Sessions I and II

THURSDAY, AUGUST 26

1:25 PM - 1:55 PM

POSTER SESSION I TRACKS: EVIDENCE GENERATION AND SYNTHESIS & GUIDELINE DEVELOPMENT

- **Make a decision: guideline development or not on fibromyalgia? (P30)**
*Anne Pauchet-Traversat, PhD,
Haute Autorité de Santé, Saint-Denis La Plaine, France*
- **Transition from the pediatric to adolescent health care service for type 1 diabetes mellitus patients (P1)**
Marta Lopez de Argumedo, MD, OSTEBA-Health technology assessment, Vitoria, Spain
- **Ten years history of CPGs (clinical practice guidelines) development in Japan (P31)**
Hiromichi Suzuki, Internationla Medical Information Center, Tokyo, Japan
- **A comparison study of national radiology guidelines (P20)**
Martin H. Reed, MD, Winnipeg, MB, Canada
- **A methodology to grade agreement in consensus groups (P26)**
Ricardo Sánchez, MD, Colombian National Cancer Institute, Bogota, Colombia
- **ADAPTE - Adapting a multidisciplinary guideline on Obstructive Sleep Apnea Syndrome (OSAS) (P12)**
David J. Bruinvels, MD, Center of Excellence of the NVAB, Utrecht, Netherlands
- **Available The Spanish version of Agree-II instrument (P21)**
Ignacio Marin-Leon, PhD, Valme University Hospital, Iberoamericana-GPC Net, Seville, Spain
- **Adapting ADAPTE: A novel methodology for the development of national clinical practice guidelines (P13)**
Orit Schieir, MSc, University of Toronto; University Health Network, Toronto, ON, Canada
- **An innovative structural model for the development of and adoption of a clinical practice guideline (CPG) (P32)**
Linda Pinsonneault, MD, AETMIS, Montreal, QC, Canada
- **Consensus recommendations on posttraumatic brain injury rehabilitation in Catalonia (Spain): Overview and methodology. (P40)**
Anna Kotzeva, MD, Catalan Agency for Health Technology Assessment, Barcelona, Spain
- **Considerations for development of Generalized Anxiety Disorder Guidelines (GAD) in the US (P7)**
Cheryl Brewster, MHA, EPI-Q, Inc., Oak Brook, IL, USA
- **Development of clinical practice guideline on osteoporosis and fragility fractures prevention: Challenges and lessons learned (P14)**
Anna Kotzeva, MD, Catalan Agency for Health Technology Assessment, Barcelona, Spain
- **Developing The Epilepsies Guideline using network meta-analysis (P9)**
Vanessa D. Nunes, MSc, National Clinical Guideline Centre, London, United Kingdom
- **Development and appraisal nursing clinical practice guidelines in Taiwan (P22)**
Kee-Hsin Chen, Taipei Medical University-Wan Fang Hospital, TAIPEI, Taiwan ROC
- **Development of Korean guideline instrument for evaluation (P23)**
Namsoon Kim, MD, Donggul, Gyeongsangbuk-Do, South Korea
- **Development of clinical practice guidelines for children with autism spectrum disorder in Singapore (P33)**
Raymond Huang, MSc, Ministry of Health, Singapore, Singapore
- **Existing clinical assessment tools and diagnostic strategies for pulmonary embolism (P3)**
Natalia Lekerika-Royo, MD, Osakidetza, Berango, Spain
- **Effectiveness of preconception care for diabetic women in improving congenital malformation rate: a systematic review and meta-analysis (P10)**
Hayfaa A. Wahabi, MBBS, Al Riyadh, Saudi Arabia
- **Electronic evidence-based evaluation of thromboprophylaxis in a tertiary care hospital in Brazil (P2)**
Airton Tetelbom Stein, MD, Ufcspa/Ulbra/Grupo Hospitalar Conceicao, Porto Alegre, Brazil
- **Engaging with Spanish speaking patients - Learning from the challenges and achievements of the Pacientes on line initiative (P41)**
Claudia Cattivera, BSc, PACINTES ON LINE, Buenos Aires, Argentina

- **Experience of developing a CPG of “Diagnosis and management of contrast media during intravascular radiologic procedures” for a teaching hospital at Bogotá, Colombia, South America (P42)**
Ana M. Torres, BScPharm, National university of Colombia, Bogota, Colombia
- **Finding guidelines to AGREE on: A quality appraisal of guidelines on the pharmacological treatment of rheumatoid arthritis (P24)**
Orit Schieir, MSc, University of Toronto; University Health Network, Toronto, ON, Canada
- **Good practice for clinical management in type 1 diabetes patients with special needs (P15)**
Marta Lopez de Argumedo, MD, OSTEBA Health Technology Assessment, Vitoria, Spain
- **Guideline development at the American Academy of Otolaryngology—head and neck surgery: 2005-2010 (P34)**
Milesh M. Patel, MS, AAO-HNS, Alexandria, VA, USA
- **Guideline development group processes: How should guideline development groups function? (P27)**
Kathryn Chamberlain, NICE, Manchester, United Kingdom
- **How can evidence be presented in a graphical form? (P8)**
Jonathan Nyong, MPH, NICE, Manchester, United Kingdom
- **Is a literature search in the cochrane library enough when preparing health technology assessment reports or clinical guidelines with focus on treatment outcome? (P36)**
Leena M. Lodenius, Finnish Medical Society Duodecim, Current Care, Helsinki, Finland
- **Improving the updating process of current care guidelines (P46)**
Mari Honkanen, The Finnish Medical Society Duodecim, Helsinki, Finland
- **Involving physiotherapy education in guideline development (P35)**
Camilla Wikström-Grotell, Arcada, Helsinki, Finland
- **Is alternative massage therapy effective by patient-reported health status in treating depressed people? (P11)**
Wen-Hsuan Hou, MD, E-Da hospital/I-Shou University, Kaohsiung County, Taiwan ROC
- **Managing conflict of interest in professional societies: An official ATS Policy Statement (P17)**
Holger J. Schunemann, MD, McMaster University, Hamilton, ON, Canada
- **Optimization of the participation of patients, clinicians and methodological group in the consensus of clinical recommendations (P28)**
Marta Lopez de Argumedo, MD, Osteaba Health Technology Assessment, Vitoria, Spain
- **Patient-centred guidance: identifying evidence on patient preferences for NICE short clinical guidelines (P38)**
Louise Foster, NICE, Manchester, England, United Kingdom
- **Patients and career participation in the elaboration of the clinical guideline (CG) of psychosocial interventions in the treatment of severe mental illness (P44)**
Maria Jose Vicente-Edo, Health Sciences Institute of Aragon, Zaragoza, Spain
- **Pervasive developmental disorders: A shared knowledge synthesis (P6)**
Joëlle M. André-Vert, MSc, Haute Autorité de Santé, La Plaine Saint Denis, France, Metropolitan
- **Rare cancers and clinical decision making (P43)**
Sonja Kersten, MSc, Association of Comprehensive Cancer Centres, Utrecht, Netherlands
- **Short guideline development processes: Producing an evidence-based guideline in 12-14 months (P39)**
Victoria J. Kelly, NICE, Manchester, United Kingdom
- **Simultaneous development of national sets of guidelines and quality indicators in the Czech Republic (P25)**
Milos Suchy, MD, Healthcare National Reference Centre, Pilsen, Czech Republic
- **The development of a cultural competence assessment tool for provincial program standards and guidelines in Nova Scotia (P18)**
Kathy Harrigan, Cardiovascular Health Nova Scotia, Halifax, NS, Canada
- **The use of diagnostic probability thresholds in the development of a guideline on the assessment and diagnosis of recent onset chest pain of suspected cardiac origin (P19)**
Angela Cooper, PhD, Royal College of Physicians, London, United Kingdom
- **Update of clinical practice guideline (CPG) on eating disorders treatments (P47)**
Maria-Dolors Estrada Sabadell, MD, Catalan Agency for HTA and Research, Barcelona, Spain
- **“Best Available” evidence does not mean “best” studies are available (P4)**
Danette Stanko-Lopp, MPH, Cincinnati Children’s Hospital Medical Center, Cincinnati, OH, USA

Poster Sessions I and II

FRIDAY, AUGUST 27

12:50 PM - 1:20 PM

POSTER SESSION II TRACKS: GUIDELINE DISSEMINATION & GUIDELINE IMPLEMENTATION

- **A new collaborative care delivery and payment model for treating depression in primary care using an evidence-based guideline as the foundation (P82)**
Cally Vinz, Institute for Clinical Systems Improvement, Bloomington, MN, USA
- **Administrative database record-linkage in the study of acute myocardial infarction (AMI) in a population sample of the city of Torino (P67)**
Elena Mittone, PharmD, PHARMACEUTICAL SERVICE ASL TO2, Torino, Italy
- **Active implementation is required even with fully automatic decision support service (P58)**
Marjukka Mäkelä, MD, National Institute for Health and Welfare, Helsinki, Finland
- **An evaluation of the NICE Quality Standards Programme pilot (P83)**
Tim Stokes, MBChB, Manchester, United Kingdom
- **An indicator to improve quality of multidisciplinary review meetings for cancer patients (P91)**
Sophie Goubet, Haute Autorité de Santé, La Plaine Saint Denis, France
- **Assessment of postacute phase management of myocardial infarction using quality indicators (P92)**
Sophie Goubet, Haute Autorité de Santé, Saint Denis La Plaine, France
- **Attitude of primary care physicians towards clinical practice guidelines (P52)**
Itziar Pérez Irazusta, PhD, Donostia-San Sebastian, Spain
- **Attitudes to clinical practice guidelines in the National Institute of Cancer in Colombia (P53)**
Ricardo Sanchez, MD, Instituto Nacional de Cancerología, Bogota, Colombia
- **BTS guideline for emergency oxygen use in adult patients (P50)**
Sally A. Welham, MA, British Thoracic Society, London, United Kingdom
- **Barriers and facilitators for guideline use in emergency practice settings: A case study (P54)**
Janet A. Curran, PhD, Ottawa Hospital Research Institute, Ottawa, ON, Canada
- **Best practice guideline integration within an undergraduate research course curriculum (P49)**
Elaine E. Santa Mina, PhD, Ryerson University, Mississauga, ON, Canada
- **Clinical guidelines from PDF-format to modern computer-based decision support (P59)**
Anne Hilde Røsv Røsvik, MDS, The Norwegian Electronic Library of Health, Oslo, Norway
- **Clinical practice guidelines in cancer in Catalonia: Assessing adherence to recommendations on rectal cancer (P64)**
Paula Manchon-Walsh, MDS, Catalan Cancer Strategy, Barcelona, Spain
- **Code SMART: The use of an early alert system to increase compliance with sepsis bundles (P93)**
Noeen Ahmad, DO, Newark Beth Israel Medical Center, Newark, NJ, USA
- **Developing quality indicators from guidelines (P94)**
Itziar Etxeandia-Ikobaltzet, PharmD, Basque Office for Health Technology Assessment, Vitoria-Gasteiz, Spain
- **Decision support capabilities of commercial EHRS and implications for guideline developers (P60)**
Adam Wright, PhD, Brigham and Women's Hospital, Boston, MA, USA
- **Delphi consensus on the feasibility of translating the American College of Emergency Physicians clinical policies into computerized clinical decision support (P61)**
Edward R. Melnick, MD, North Shore University Hospital, Long Island City, NY, USA
- **Development of a methodological handbook for the implementation of CPG in the Spanish National Health System (P70)**
José Miguel Carrasco, GuiaSalud-Health Sciences Institute of Aragon, Zaragoza, Spain
- **Dissemination of guidelines: Pilot study in Hungary (P51)**
Erika Kis, MD, TUDOR Network and Medical University of Szeged, Szeged, Hungary
- **Does format of clinical guidelines influence acceptability/uptake by healthcare professionals? (P55)**
Kathryn Chamberlain, NICE, Manchester, United Kingdom
- **Experiences of guideline implementation (P71)**
Heli Kangas, MSc, Finnish Association of Physiotherapists, Helsinki, Finland
- **GIN Kindergarten: A comprehensive educational program for undergraduate medical students (P87)**
Radim Lícenik, MD, Faculty of Medicine, Palacky University, Olomouc, Czech Republic

- **Guideline implementation for patients with non-small cell lung carcinoma in the Netherlands. Towards Improvements in the quality of care (P95)**
Sonja Kersten, MSc, Association of Comprehensive Cancer Centres, Utrecht, Netherlands
- **How can we improve guideline implementation? Resource implications of differing approaches (P72)**
Stephanie Hylmar, BSc, University Health Network, Toronto, ON, Canada
- **How useful is the Guideline Development Group's (GDG) BiliWheel as a tool for implementing their guidance on management decisions about neonatal jaundice? (P73)**
Hugh McGuire, MSc, National Collaborating Centre for Women's and Child, London, United Kingdom
- **How useful is the NICE Neonatal Jaundice Parent Information Factsheet in comparison to other parent information leaflets in terms of reducing adverse outcomes of neonatal jaundice? (P74)**
Hugh McGuire, MSc, National Collaborating Centre for Women's and Child, London, United Kingdom
- **Implementation of the Guidelines for the Diagnosis and Management of Asthma, 2007 (Guidelines) in Suffolk County (New York)-operated health centers (SCHCs) (P84)**
Lewis R. Mooney, MD, Suffolk County (NY) Dept. of Health Services, Coram, NY, USA
- **Improving the quality of care of COPD patients in internal medicine residency group by implementing the American Society Guidelines (P65)**
Ali M. Eskandar, MD, McLaren Regional Medical Center, Flint, MI, USA
- **Information gap between urban and rural municipalities regarding cancer screening guidelines (P56)**
Chisato Hamashima, MD, National Cancer Center of Japan, Tokyo, Japan
- **Legal aspects of CPGs (P79)**
Radim Licenik, MD, Palacky University Faculty of Medicine, Olomouc, Czech Republic
- **Medicolegal interprofessional problem based learning focused on clinical practice guidelines (P88)**
Radim Licenik, MD, Palacky University Faculty of Medicine, Olomouc, Czech Republic
- **Practical tools to improve implementation of a Primary Care Stroke Clinical Practice Guideline (P66)**
Javier Gracia, Health Technology Assessment Unit, Madrid, Spain
- **Quality of care in the management of cardiovascular risk factors in primary care of the Basque Country before the implementation of three clinical practice guidelines (P80)**
Arritxu Etxeberria, Osakidetza. Basque Health Service., Hernani, Gipuzkoa, Spain
- **Recommendations are not enough: Creating a toolbox to support stroke guideline uptake (P75)**
Patrice Lindsay, PhD, Canadian Stroke Network, Etobicoke, ON, Canada
- **Shifting paradigms: Advancing practice guideline development & implementation for an eHealth approach (P62)**
Julie Makarski, BSc, McMaster University, Hamilton, ON, Canada
- **The Critical Illness Network: A train-the-trainer model for guideline implementation (P76)**
Joan Schwaba, MS, American Dietetic Association, Chicago, IL, USA
- **The BREATH Study: The Brazilian experimental algorithm for the treatment of bipolar disorders in the public health system (P81)**
Airtton Tetelbom Stein, MD, Ufcspa/Ulbra/GHC, Porto Alegre, Brazil
- **The development of a common guideline framework for physicians and payers (P63)**
Matthew Stanhope, PT, La Trobe University, South Melbourne, VIC, Australia
- **The German Medical eLibrary: A Web-based knowledge portal for medical professionals (P48)**
Thomas Bunk, Berlin, Germany
- **The Map of Medicine's Adoption Framework: Localization of guideline-based care pathways (P89)**
Gajan Srikanthan, MBBS, Map of Medicine, London, United Kingdom
- **The Physicians' Practice Assessment Questionnaire: A new tool to assess asthma and chronic pulmonary obstructive disease guidelines implementation (P97)**
Louis Philippe Boulet, MD, IUCPQ, Quebec, Canada
- **The role and benefits of partnership with your asthma coalition to disseminate and implement asthma disease management guidelines into a closed health-care system (P86)**
Mary E. Cataletto, MD, Winthrop University Hospital, Mineola, NY, USA
- **The guideline cycle in Youth Health Services (YHS): Policy, research and practice interconnected (P57)**
Marga Beckers, MA, National Institute on Public Health & Environment, Bilthoven, Netherlands
- **The revised guideline "Atrial fibrillation" in primary care: assessing the room for improvement of antithrombotic therapy (P77)**
Wim Opstelten, PhD, Dutch College of General Practitioners, Utrecht, Netherlands

Social Events and Networking Opportunities

Welcoming Reception

Chicago Marriott Downtown Magnificent Mile
Chicago Ballroom – 5th Floor
Wednesday, August 25, 2010
7:30 PM – 9:00 PM

Gala Event – Odyssey II Sunset Dinner Cruise

Navy Pier, Chicago, Illinois, USA
Friday, August 27, 2010
6:00 PM – 11:00 PM

Trolley transportation pickup and return location:

Chicago Marriott Downtown Magnificent Mile
Rush Street Entrance
540 North Michigan Avenue
Chicago, IL 60611 USA
T: (800) 228-9290

Begin your gala experience by boarding one of Chicago's popular tourist attractions, the Chicago Trolley cars. The trolley will transport you on a scenic ride to experience downtown Chicago on the way to the Odyssey II dinner cruise on beautiful Lake Michigan. Trolley transportation service begins at 6:00 PM at the Chicago Marriott Downtown Magnificent Mile. The Odyssey II Cruise Ship is docked at downtown Chicago's Navy Pier.

The recommended attire for the Gala Event is summer cocktail casual dress. Jeans are not permitted aboard the Odyssey II Dinner Cruise Ship. It is also suggested that you bring a light jacket or shawl, as evening temperatures on Lake Michigan can be cool.

Boarding on the Odyssey II begins at 7:00 PM for a 7:45 PM departure.



Additional Meetings

Annual General Meeting (AGM)—Open to ALL G-I-N Members

The Annual General Meeting will be held on Wednesday, August 25, from 5:30 PM to 7:00 PM in the Indiana/Iowa room on the 6th floor of the Chicago Marriott Downtown Magnificent Mile. All G-I-N members are invited to attend.

G-I-N United States Interest Group Meeting

All G-I-N Conference 2010 attendees are invited to participate in an exploratory meeting for the G-I-N United States Interest Group. This informal discussion will take place on Thursday, August 26, from 5:45 PM to 7:15 PM at the Chicago Marriott Downtown Magnificent Mile in the Indiana/Iowa room on the 6th floor.

The purpose of this exploratory meeting is to assess interest in a United States interest group within G-I-N. Goals of the interest group might include the following:

1. Discussing regional issues in the United States related to guideline development
2. Identifying and sharing best practices
3. Improving communication among guideline developers in the United States
4. Creating win-win relationships with G-I-N and the international community
5. Developing strategies to share resources and adapt existing guidelines

This exploratory meeting is open to all who wish to contribute, but individuals and groups in the following categories may find the group of particular interest:

- Professional medical associations with an interest in guideline development
- Governmental agencies that support or coordinate guideline activities
- Individuals seeking to enhance personal or organizational guideline efforts
- United States attendees interested in new ideas and collaborative opportunities
- International attendees wishing to share insights and experience

Exhibitors

Agency for Healthcare Research and Quality

540 Gaither Road
Rockville, MD 20850
www.ahrq.gov

The Agency for Healthcare Research and Quality (AHRQ) is the lead federal agency charged with improving the quality, safety, efficiency, and effectiveness of health care for all Americans. Within the Department of Health and Human Services, AHRQ supports research to improve the quality of health care and promote evidence-based decisions.

American Academy of Otolaryngology – Head and Neck Surgery (AAO-HNS)

1650 Diagonal Road
Alexandria, VA 22314
www.entnet.org

The American Academy of Otolaryngology – Head and Neck Surgery, one of the oldest medical associations in the nation, represents nearly 12,000 physicians and allied health professionals who specialize in the diagnosis and treatment of disorders of the ears, nose, throat, and related structures of the head and neck.

American College of Chest Physicians (ACCP)

3300 Dundee Road
Northbrook, IL 60062
www.chestnet.org

The ACCP is the global leader in providing education in cardiopulmonary, critical care, and sleep medicine to optimize health and advance patient care. Visit our booth to review our evidence-based guidelines and clinical resources, simulation education courses, practice management and advocacy efforts, patient education materials, and more.

American College of Occupational and Environmental Medicine (ACOEM)

25 Northwest Point Boulevard, Suite 700
Elk Grove Village, IL 60007
www.acoem.org

The American College of Occupational and Environmental Medicine is the preeminent professional society devoted to treatment of injured workers and has been developing musculoskeletal guidelines since 1997. The third edition of the practice guidelines currently being released includes thousands of strength-of-evidence recommendations developed with an online evidence-based publishing platform developed by Indico Solutions.

BMJ Group

BMA House
Tavistock Square
London WC1H 9JR, England
<http://group.bmj.com>

The BMJ Evidence Centre provides evidence-based knowledge to all health-care professionals. *Quality and Safety* (QSHC) is a bimonthly leading international journal providing information to improve patient safety and quality of care. Visit our booth to find out more about these and other products offered by the BMJ Group or go to <http://group.bmj.com>.

Capacity Enhancement Program, Canadian Partnership Against Cancer

McMaster University
Henderson Suite-G Wing 2nd Flr
711 Concession Street
Hamilton, ON, L8V 1C3, Canada
<http://fhs.mcmaster.ca/cep>

The Capacity Enhancement Program is a strategic initiative of the Cancer Guidelines Advisory Group of the Canadian Partnership Against Cancer. Its mandate is to improve the quality and use of cancer guidelines



through three interrelated strategies: training, education, and skills acquisition; the inventory of cancer guidelines; and cancer evidence casebook.

CECity.com, Inc.

285 Waterfront Drive East
Suite 100
Homestead, PA 15120
www.cecocity.com

CECity is the leader in performance and quality improvement, plus lifelong learning technologies. CECity's partners are health-care's premier organizations, including medical certifying boards, medical specialty societies, medical societies, quality organizations, academic medical centers, medical education companies, and many others.

Through CECity, its partners and their members gain access to custom-branded Web-based solutions and collaborative distribution networks for eCME, CME practice management, PI/PI-CME, registries, physician/patient-centered medical homes, social networking, maintenance of certification, lifelong learning portfolios, outcomes, and pay for performance.

The Cochrane Collaboration

1 Stewart Street
2nd Floor
Ottawa, ON, Canada

The Cochrane Collaboration is an international, independent, not-for-profit organization that makes up-to-date information about the effects of health care available worldwide. We produce systematic reviews of health-care interventions; Cochrane reviews are the most comprehensive, reliable source of evidence for health practice. "The Cochrane Collaboration is an enterprise that rivals the Human Genome Project in its potential implications for modern medicine." – *The Lancet*

ECRI Institute

5200 Butler Pike
Plymouth Meeting, PA 19462
www.ecri.org

ECRI Institute, an independent nonprofit that researches best approaches to patient care and an evidence-based practice center, evaluates health-care technologies and services along the continuum of evidence. ECRI Institute's unbiased evidence reports, forecasting resources, membership programs, and consulting services help guide health-care decision making and medical policy.

International Guidelines Center

5740 Executive Drive
Suite 220
Baltimore, MD 21228
www.guidelinecentral.com

International Guidelines Center (IGC) is dedicated to providing health-care professionals with evidence-based clinical decision-support tools that are current, practical, and easily accessible. We partner with over 20 medical societies and government agencies to provide quick-reference tools that physicians can rely on for credible guidance in the management of a medical condition. Our Mission: Support global implementation of guideline-based care by making innovative tools accessible to providers at the point of need.

New York Academy of Medicine

1216 Fifth Avenue
New York, NY, 10029
www.ebmny.org

The New York Academy of Medicine has developed the Teaching Evidence Assimilation for Collaborative Health Care (TEACH): a program for integrated evidence-based medicine skills acquisition from guideline development through adaptation and implementation through individualized care.



Welcome to Chicago

Located on beautiful Lake Michigan, Chicago is an exciting, sophisticated city, with world-renowned architecture, museums, attractions, and special events. One of the most challenging decisions to make regarding your time in Chicago will be determining what to do and see. Consider these options:

Millennium Park

Visit this award-winning center for art, music, architecture, and landscape design. There are many unique aspects of the park, and make sure you visit the very popular Cloud Gate sculpture, as well as the interactive Crown Fountain.

Magnificent Mile

Take time to walk The Magnificent Mile, the location of the G-I-N Conference 2010 headquarters hotel. Located on the northern part of Michigan Avenue, between the Chicago River and Lake Shore Drive, the "Mag Mile" is Chicago's version of the Champs-Élysées: a grand wide boulevard with exclusive shops, museums, restaurants, and classy hotels.

Tall Ships at Navy Pier

Make your way over to Navy Pier to view over 20 majestic and historic Tall Ships from around the world, as they make a rare return to Chicago for 1 week only. Before you leave, take a ride on the 15 story-tall Ferris wheel, and enjoy an incredible view of the city from 150 feet up in the air.

Grant Park

Proudly referred to as Chicago's "front yard," Grant Park is among the city's loveliest and most prominent parks and is the site of three world-class museums—The Art Institute of Chicago, The Field Museum, and the John G. Shedd Aquarium. Grant Park's centerpiece is the Clarence Buckingham Memorial Fountain, built in 1927 to provide a monumental focal point, while protecting the park's breathtaking lakefront view.

Theater

Take in a performance of *Billy Elliot the Musical*, winner of ten Tony Awards, including "Best Musical," playing at the Ford Theatre for the Performing Arts. Or, head over to the Cadillac Palace Theatre for a performance of *Shrek The Musical*, as it begins its national tour in Chicago. Prefer something less scripted? The improvisational sketch comedy show, *The Second City*, is a fun way to spend an evening and has consistently been a starting point for many comedians and award-winning actors.

Chicago White Sox

Head to the south side and participate in America's favorite pastime at family-friendly US Cellular Field, where the Chicago White Sox are playing the New York Yankees.

And So Much More...

Stop by the registration desk to pick up brochures about these and other Chicago attractions. For more ideas, visit www.choosechicago.com or www.chicagotraveler.com.

Continuing Medical Education (CME) Credits

Accreditation Statement

The ACCP is accredited by the Accreditation Council for Continuing Medical Education (ACCME) to provide continuing medical education for physicians.

How To Obtain CME/CE Credit

Go to www.chestnet.org/accp/cme to review the detailed instructions for how to obtain your CME/CE credit. Once you have read the provided directions carefully, please continue by clicking on the "CME Certificates" button on the right side of your screen.

Friday, October 22, 2010 is the last day to complete evaluations and obtain your electronic CME/CE certificate.

Designation Statement

CME Credit

The ACCP designates this educational activity for a maximum of 29 *AMA PRA Category 1 Credits*[™]. Physicians should only claim credit commensurate with the extent of their participation in the activity.

Disclosure of Faculty Conflict of Interest

The ACCP remains strongly committed to providing the best available evidence-based clinical information to participants of this educational activity and requires an open disclosure of any potential conflicts of interest identified by our faculty members. It is not the intent of the ACCP to eliminate all situations of potential conflict of interest, but rather to enable those who are working with the ACCP to recognize situations that may be subject to question by others. All disclosed conflicts of interest are reviewed by the educational activity course director/chair, the Education Committee, or the Conflict of Interest Review Committee to ensure that such situations are properly evaluated and, if necessary, resolved. The ACCP educational standards pertaining to conflict of interest are intended to maintain the professional autonomy of the clinical experts inherent in promoting a balanced presentation of science. Through our review process, all ACCP CME activities are ensured of independent, objective, scientifically balanced presentations of information. Disclosure of any or no relationships will be made available on-site during all educational activities.

Disclosures

All information appears as supplied by faculty.

Cheryl Brewster, MHA

Consultant fee, speaker bureau, advisory committee, etc.: Cheryl Brewster (presenter), a consultant with EPI-Q, Inc., received on behalf of the company a consultation fee for developing, coordinating, and managing this guideline synthesis.

Klara Brunnhuber, PhD

Other: Systematic reviews on the management of patients with heart failure and a concomitant condition (diabetes; COPD) were commissioned by Ovations (a business of UnitedHealth Group), but conducted with full editorial independence.

Martin Eccles, MD

Other: Martin Eccles is Co-Editor in Chief of Implementation Science in respect of which he receives an annual honorarium of £500.

Michael K. Gould, MD, FCCP

Grant monies (from sources other than industry): Grant support from NIH/NCI to perform studies of screening, diagnosis and staging in lung cancer.

Lisa T. Haskell, MS

Employee: Lisa T. Haskell is an employee of ECRI Institute, the U.S. Agency for Healthcare Research and Quality (AHRQ)-sponsored contractor for the National Guideline Clearinghouse (NGC) and the National Quality Measures Clearinghouse (NQMC).

Carel Hulshof, PhD

Product/procedure/technique that is considered research and is NOT yet approved for any purpose.: The subject of my presentation is a combined guideline development and research

project. First, we have developed a draft guideline on prevention of weight gain in workers. In the second stage, we are evaluating this draft guideline on its (cost-) effectiveness in a randomised controlled trial (RCT). Only if the RCT shows evidence of the effectiveness of the draft guideline in daily practice, we will publish it as a guideline.

Finn Børlum Kristensen, MD, PhD

Grant monies (from sources other than industry): Public grant to Dr. Kristensen's institution, National Board of Health, as coordinator and main beneficiary of a 5.9 million Euro grant from European Commission, DG SANCO, 2009 2303 European Network for HTA, EUnetHTA, Joint Action.

Sonja Kersten, MSc

Grant monies (from sources other than industry): This project is granted by ZonMw, the Netherlands organisation for health research and development

Rosemary M. Killeen, BScPharm

Consultant fee, speaker bureau, advisory committee, etc.: Rosemary Killeen received an honorarium from Merck Frosst Canada in June 2009 for acting as a Moderator at an Educational Event on diabetes management. The CPJ Diabetes guidelines were used as one of the many reference sources for this presentation.

Iikka Kunnamo, MD

Employee: I am a salaried employee of Duodecim Medical Publications Ltd., the company that develops and licenses the EBMeDS decision support service.

Sandra Zelman Lewis, PhD

Employee: American College of Chest Physicians. In charge of ACCP Guidelines and Consensus Statements.

Consultant fee, speaker bureau, advisory committee, etc.: Presentations: Institute of Medicine (4), American Academy of Otolaryngology, AcademyHealth. No honoraria received for any of these.

Marjukka Mälelä, MD

Fiduciary position (of any organization, association, society, etc, other than ACCP: Chair of INAHTA (the International Network of Agencies for Health Technology Assessment) and an Observer in the Board of HTAi (Health Technology Assessment International).

Other: My organisation (THL) receives a yearly compensation from the Cambridge University Press for my position as the Editor-in-Chief for the *International Journal of Technology Assessment in Health Care*.

Catherine Marshall

Consultant fee, speaker bureau, advisory committee, etc.: I have received a consultant fee for providing advice to the government agency that funded this project, The NZ Pharmaceuticals management agency.

Mark Monteforte, MD

Employee: Mark Monteforte is an employee of ECRI Institute, the U.S. Agency for Healthcare Research and Quality (AHRQ)-sponsored contractor for the National Guideline Clearinghouse (NGC) and the National Quality Measures Clearinghouse (NQMC).

Daniel R. Ouellette, MD, FCCP

Consultant fee, speaker bureau, advisory committee, etc.: Speaker Bureau: Boehringer Ingelheim, Pfizer, and AstraZeneca.

Holger J. Schunemann, MD

Other: Dr. Schunemann is documents editor for the American Thoracic Society and member of the executive committee of the 9th edition of the ACCP Antithrombotic Guidelines.

Peter Selby, MBBS

Grant monies (from sources other than industry): Health Canada has funded Canadapt but the views expressed are not those of the funder. Ministry of Health Promotion government of Ontario, Canada for training in smoking cessation and studies to evaluate the distribution of stop smoking medications in the community. Governments/Health agencies (British Columbia, Alberta, North West Territories, Saskatchewan, Manitoba) to deliver smoking cessation training and or advice regarding cessation systems.

Grant monies (from industry related sources): Pfizer Inc- manufacturer of varenicline; Johnson and Johnson- manufacturer of nicotine replacement therapy; Biovail- manufacturer of bupropion.

Fiduciary position (of any organization, association, society, etc, other than ACCP: Ontario Representative: College of Family Physicians of Canada and Canadian Psychiatric Association- Shared Care Co-Chair Health Protection and Promotion, Ontario College of Family Physicians.

Consultant fee, speaker bureau, advisory committee, etc.: Pfizer Inc- manufacturer of

vareniciline; Johnson and Johnson- manufacturer of nicotine replacement therapy.

Matthew Stanhope, PT

Employee: Matthew Stanhope is an employee of Indico Solutions Pty Ltd. Indico Solutions have developed a treatment guideline software package for the ACOEM Practice Guidelines.

Melanie Swan, MPH

Employee: Melanie Swan is an employee of ECRI Institute, the U.S. Agency for Healthcare Research and Quality (AHRQ)-sponsored contractor for the National Guideline Clearinghouse (NGC) and the National Quality Measures Clearinghouse (NQMC).

Craig J. Whittington, PhD

Employee: I am employed by the National Collaborating Centre for Mental Health, who is funded by the National Institute for Health & Clinical Excellence (NICE) to produce clinical guidelines and work with NICE International to provide training in guidance development.

Christopher J. Wolfkiel

Fiduciary position (of any organization, association, society, etc, other than ACCP): I am the Director of ACOEM's Practice Guidelines.

Julia Worswick, BA

Grant monies (from sources other than industry): The Cochrane Effective Practice and Organisation of Care review group receives grant monies from the Canadian Agency of Drugs and Technologies in Health for the provision of data for their Rx for Change database.

The following have declared no conflicts of interest:

Noeen Ahmad, DO
Rasmieh Ayed Al Zeidan, BScPharm

Jose M. Andrert, MSc
Donna K. Angus, MS
Mark S. Antman, DDS
Daniel Anzola, MD
Marga Beckers, MA
Mary J. Bell, MD
Onil Bhattacharyya

Antoine Boivin, MD
Louis Philippe Boulet, MD
Cynthia Boyd, MD
Melissa C. Brouwers, PhD
David J. Bruinvels, MD
Thomas Bunk
Jako Burgers, PhD
Denise Campbell-Scherer, MD
Jos iguel Carrasco
Mary E. Cataletto, MD
Claudia Cattivera, BSc
Kathryn Chamberlain
Wiley Chan, MD
Kee-Hsin Chen
Lee-Yee Chong, PhD
Vivian Coates, MBA
Ceci Connolly
Robert Cook, MBBS
Angela Cooper, PhD
Jane Cowl, MSc
Kathy Cummings, MA
Janet A. Curran, PhD
Catherine DeAngelis, MD
Hans de Beer, MD
Elvira M.E. Den Breejen, MD
Rikie Deurenberg, MS
Kay Dickersin, PhD
Jean-Pierre Duplantie, DrPH
Lisa Durocher, MSc
Michaela Eikermann, MD
Ali El-Ghorr, PhD
Ali M. Eskandar, MD
Maria-Dolors Estrada Sabadell, MD
Itziar Etxeandia-Ikobaltzet, PharmD
Arritxu Etxeberria
Martin Faix, JD
Elisabetta Fenu, MS
Marie Ferrua
Liat Fishman, MD
Anita Fitzgerald
Margot Ah Fleuren, PhD
Markus Follmann, MD
Louise Foster
Gerdien Franx, MS
Ted Ganiats, MD
Sophie Goubet
Javier Gracia
Ian Graham, PhD
Roberto Grilli, MD
Sophie Guerin
Iñaki Gutiérrez-Ibarluzea, PhD
Gill Gyte, BSc
Chisato Hamashima, MD
Robin T. Harbour, BSc
Kathy Harrigan
Jeffrey S. Harris, MD
Christa Harstall, MHSA
Mari Honkanen
Wen-Hsuan Hou, MD
Nancy Huang, MPH

Raymond Huang, MSc
Heddy Hubbard, PhD
Susan Huckson, BSc
Belinda Ireland, MD
Richard S. Irwin, MD
Kim Jeong
Clare N. Jones, MS
Norman Kahn, MD
Heli Kangas, MSc
Monika Kastner
Caroline A. Keir, MS
Victoria J. Kelly
Eeva Ketola, MD
Samyra H.J. Keus, PhD
Khalil Khoury, BScPharm
Namsoon Kim, MD
Erika Kis, MD
Anna Kotzeva, MD
Ken N. Kuo, MD
Thomas Langer
Sue Latchem, RN
Natalia Lekerika-Royo, MD
Radim Licenik, MD
Patrice Lindsay, PhD
Leena M. Lodenius
Marta Lopez de Argumedo, MD
Marjolein Lugtenberg, MS
Fergus MacBeth, MA
Julie Makarski, BSc
Paula Manchon-Walsh, MDS
Logan N. Manikam, MBChB
Ignacio Marin-Leon, PhD
Nancy A. Matthew-Maich, PhD
Hugh McGuire, MSc
Edward R. Melnick, MD
Philippa F. Middleton
Elena Mittone, PharmD
Najoua Mlika-Cabanne, MD
Mohd Aminuddin Mohd.Yusof, MPH
Lewis R. Mooney, MD
Rebecca L. Morgan, MPH
Joel Moss, PhD
Ian T. Nathanson, MD, FCCP
Arnolda Petra Nauta, PhD
David Nielsen, MD
Mary Nix, MS
Monika Nothacker, MD
Vanessa D. Nunes, MSc
Jonathan Nyong, MPH
Rachel O. Mahony, PhD
Terry O'Kelly, MD
Wim Opstelten, PhD
Jennifer J. Padberg, MPH
Carmel Parnell, MPH
Marama Parore
Milesh M. Patel, MS
Alice K. Pau, PharmD
Anne Pauchet-Traversat, PhD
Susan M. Phillips, PhD
Linda Pinsonneault, MD
Lise Poissant, PhD

Piet N. Post, PhD
Marjo Poth, MS
Itziar Perez Irazusta, PhD
Renli Qiao, MD, FCCP
Ilse Raats, PhD
Martin H. Reed, MD
Stefanie Reken, MS
Craig Robbins, MD
Jess Rogers, BA
Richard Rosenfeld, MD
Jennifer Ross, BSc
Murray N. Ross, PhD
Anne Hilde Rosvik, MDS
Alfred W. Sackeyfio
Ian J. Saldanha, MPH
Ricardo Sanchez, MD
Elaine E. Santa Mina, PhD
Laura Sawyer, MS
Corinna Schaefer
Orit Schieir, MSc
Joan Schwaba, MS
Ann Scott, PhD
Danielle Sent, PhD
Richard Shiffman, MD
Faisal Siddiqui, MSc
Raija Sipilä, MD
Dean F. Sittig, PhD
Katrina L. Sparrow, MS
Gajan Srikanthan, MBBS
Danette Stanko-Lopp, MPH
Airton Tetelbom Stein, MD
Tim Stokes, MBChB
Milos Suchy, MD
Nichole Taske, PhD
Allison Tong, PhD
Ana M. Torres, BScPharm
Mario G. Tristan, MD
Sara Twaddle, PhD
Rosina M. Ullman, PhD
Seda Usabutun, MD
Marianne van den Berg, PhD
Trudy van der Weijden
Maria Jose Vicente-Edo
Cally Vinz
Karen J. Vonderhaar, MS
Hayfaa A. Wahabi, MBBS
Holger Wahl
Susanne Weinbrenner, MD
Sally A. Welham, MA
Michel J. Wensing, PhD
Maggie Westby, PhD
Gert Westert, PhD
Tjerk Wiersma, MD
Camilla Wikströtel
Mallory D. Woiski, MD
James Woodcock, MD
Steven Woolf, MD
Adam Wright, PhD

Index

A

Addrizzo-Harris, Doreen 3, 2, 20, 23
Ahmad, Noeen 34
Ahn, Hyeongsik 2, 22, 27, 31
André-Vert, Joëlle M. 33
Angus, Donna K. 26
Antman, Mark S. 30
Anzola, Daniel 19, 25
Argumedo, Marta Lopez de 32, 33
Atkins, David 2

B

Beckers, Marga 35
Beer, Hans de 29
Bell, Mary J. 27
Berg, Marianne van den 20
Bhattacharyya, Onil 19
Boivin, Antoine 17, 30
Boulet, Louis Philippe 35
Boyd, Cynthia 22
Breejen, Elvira M.E. Den 22
Brewster, Cheryl 32
Brouwers, Melissa C. 19, 24, 28
Bruinvels, David J. 32
Brunnhuber, Klara 18
Bunk, Thomas 35
Burgers, Jako 18, 21

C

Campbell-Scherer, Denise 19
Carrasco, José Miguel 34
Cataletto, Mary E. 35
Cattivera, Claudia 32
Chalmers, Sarah 17
Chamberlain, Kathryn 33, 34
Chan, Wiley 19, 23
Cheng, Jessica 20
Chen, Kee-Hsin 32
Chong, Lee-Yee 23
Coates, Vivian 29
Connolly, Ceci 10, 18
Cook, Robert 29
Cooper, Angela 33
Cowl, Jane 17, 20
Cummings, Kathy 23
Curran, Janet A. 34

D

Davis, Dave 2, 24
DeAngelis, Catherine D. 10, 24
Deurenberg, Rikie 18, 19
Dickersin, Kay 2, 10, 17, 19, 26, 27
Duplantie, Jean-Pierre 30
Durocher, Lisa 24

E

Eccles, Martin 11, 21
Eikermann, Michaela 25
El-Ghorr, Ali 25
Eskandar, Ali M. 35
Etxeandia-Ikobaltzet, Itziar 34
Etxeberria, Arritxu 35

F

Fenu, Elisabetta 25
Ferrua, Marie 28
Fishman, Liat 28
Fitzgerald, Anita 22
Fleuren, Margot Ah 25
Follmann, Markus 27
Foster, Louise 33
Franx, Gerdien 28

G

Gagliardi, Anna R. 28
Ganiats, Theodore G. 11, 26
Goubet, Sophie 34
Gould, Michael K. 17
Gracia, Javier 20, 27, 35
Graham, Ian 2, 22
Grilli, Roberto 11, 21
Guerin, Sophie 28
Gutiérrez-Ibarluzea, Iñaki 19, 27
Gutterman, David D. 21
Gyte, Gill 12, 17, 26

H

Ham, Alida van der 30
Hamashima, Chisato 35
Harbour, Robin T. 23, 29
Harding, Susan M. 2
Harrigan, Kathy 33
Harris, Jeffrey S. 19
Harstall, Christa 25
Haskell, Lisa T. 26
Honkanen, Mari 33
Hou, Wen-Hsuan 33
Huang, Nancy 20
Huang, Raymond 32
Hubbard, Heddy 20
Huckson, Susan 22, 25
Hulshof, Carel 25
Hylmar, Stephanie 35
Hyzy, Robert C. 2

I

Irazusta, Itziar Pérez 34
Ireland, Belinda 19
Irwin, Richard S. 23

J

Jeong, Kim 25
Jones, Clare N. 23

K

Kahn, Norman 21
Kangas, Heli 34
Kastner, Monika 28
Kato, Norm 2
Keir, Caroline A. 23
Kelly, Victoria J. 23, 33
Kersten, Sonja 20, 27, 33, 35
Ketola, Eeva 2, 21, 30
Keus, Samyra HJ 25
Killeen, Rosemary M. 30
Kim, Namsoon 32
Kis, Erika 34
Kleinpell, Ruth M. 28
Kotzeva, Anna 32
Kristensen, Finn Børlum 12, 31
Kunnamo, Ilkka 29
Kuo, Ken N. 25

L

Lang, Eddy 2
Langer, Thomas 25
Lekerika-Royo, Natalia 32
Lewis, Sandra Zelman 32
Licenik, Radim 30, 34, 35
Lindsay, Patrice 35
Lodenus, Leena M. 18, 33
Lugtenberg, Marjolein 18

M

Macbeth, Fergus 12, 31
Mahony, Rachel O 19
Makarski, Julie 24, 35
Mäkelä, Marjukka 13, 24, 34
Manchon-Walsh, Paula 34
Manikam, Logan N. 20
Marin-Leon, Ignacio 22, 32
Marshall, Catherine 26, 27
Mathur, Praveen N. 2
Matthew-Maich, Nancy A. 20
Maurer, Janet 2, 28, 30
McGuire, Hugh 35
Melnick, Edward R. 34
Metersky, Mark 2
Middleton, Philippa F. 22
Mina, Elaine E. Santa 34
Mittone, Elena 34
Mlika-Cabanne, Najoua 29
Mohd.Yusof, Mohd Aminuddin 25
Monteforte, Mark 29
Mooney, Lewis R. 23, 35
Moores, COL Lisa K. 2
Moore, Val 2, 26
Morgan, Rebecca L. 28
Moss, Joel 13, 24
Moyer, Virginia 2, 22, 25

N

Nathanson, Ian T. 2, 17, 25, 30
Nauta, Arnolda Petra 30
Nielsen, David 21
Nix, Mary 29
Nothacker, Monika 28
Nunes, Vanessa D. 32
Nyong, Jonathan 20, 33

O

O'Kelly, Terry 30
Ollenschlaeger, Guenter 31
Opstelten, Wim 35
Ouellette, Daniel R. 2, 17, 25

P

Padberg, Jennifer J. 13, 18
Parnell, Carmel 30
Parore, Marama 27
Patel, Milesh M. 33
Pau, Alice K. 26
Pauchet-Traversat, Anne 32
Phillips, Susan M. 2, 21, 22
Pinsonneault, Linda 32
Poissant, Lise 26
Post, Piet N. 22
Poth, Marjo 18

Q

Qaseem, Amir 2, 19, 23, 25
Qiao, Renli 29

R

Raats, Ilse 30
Reed, Martin H. 20, 26, 32
Reken, Stefanie 19
Rico-Iturrioz, Rosa 2, 19, 28
Robbins, Craig 25
Rogers, Jess 19
Rosenfeld, Richard 2, 20, 21, 24, 28, 30
Ross, Jennifer 20
Ross, Murray N. 25
Røsvik, Anne Hilde Røsv 34

S

Sabadell, Maria-Dolors Estrada 33
Sackeyfio, Alfred W. 22
Sakala, Carol 17
Saldanha, Ian J. 28
Sanchez, Ricardo 27, 32, 34
Sawyer, Laura 25
Schaefer, Corinna 20
Schieir, Orit 32, 33
Schunemann, Holger J. 19, 30, 33
Schwaba, Joan 35
Scott, Ann 19
Selby, Peter 27
Sent, Danielle 29
Shiffman, Richard 3, 2, 18, 24, 29
Siddiqui, Faisal 22
Sipila, Raija 21
Sittig, Dean F. 29
Sparrow, Katrina L. 20
Srikanthan, Gajan 28, 35
Stanhope, Matthew 35
Stanko-Lopp, Danette 33
Stein, Airton Tetelbom 23, 32, 35
Stokes, Tim 21, 28, 30, 34
Suchy, Milos 33
Suzuki, Hiromichi 32
Swan, Melanie 29

T

Taske, Nichole 30
Tong, Allison 30
Torres, Ana M. 33
Tristan, Mario G. 27
Twaddle, Sara 3, 29

U

Ullman, Rosina M. 30
Usubutun, Seda 24

V

Vicente-Edo, Maria Jose 33
Vinz, Cally 34
Vonderhaar, Karen J. 22

W

Wahabi, Hayfaa A. 27, 32
Wahl, Holger 26
Weijden, Trudy van der 14, 17, 26
Weinbrenner, Susanne 30
Welham, Sally A. 34
Wensing, Michel 14, 21
Westby, Maggie 22
Westert, Gert 18
Whittington, Craig J. 24
Wiersma, Tjerk 22
Wikström-Grotell, Camilla 33
Woiski, Mallory D. 30
Wolfkiel, Christopher J. 27, 28
Woodcock, James 18
Woolf, Steven H. 14, 18
Worswick, Julia 20
Wright, Adam 34

Z

Zeidan, Rasmieh Ayed Al 19

**See you next year in
Seoul, South Korea, for the
8th G-I-N Conference!**

Inchon Memorial Hall, Korea University

August 28 - 30, 2011

ww.g-i-n.net/events/8th-conference

